

# Remington



## HIGH POWER RIFLE BOLT ACTION REPEATER ADL, BDL and VARMINT GRADES

### MODEL 700

# INSTRUCTION FOLDER and PARTS PRICE LIST

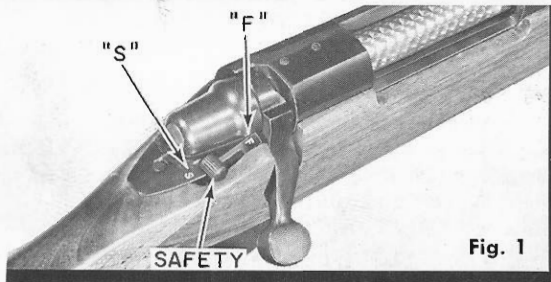

Fig. 1

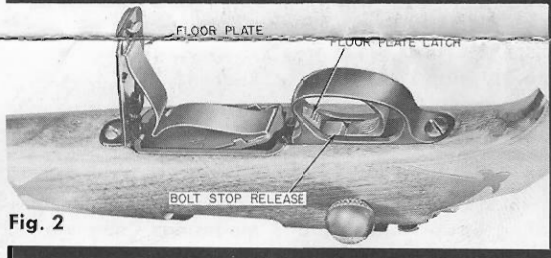

Fig. 2

**ON SAFE** (Fig. 1) — Rotate side lever safety at right rear of receiver to rear stop position marked "S" on receiver. Bolt handle will be locked down and trigger will not fire rifle.

**FIRE** — Rotate safety forward to front stop position marked "F" on receiver. Trigger can be pulled to fire rifle or bolt handle raised to open action.

**Caution:** Before firing make sure barrel is clean, free of heavy oil, grease, or any obstruction.

**TO SINGLE LOAD** — Raise bolt handle to unlock bolt. Pull bolt handle back to open action. Load single cartridge upon magazine follower or directly into chamber. Close bolt and lower bolt handle to lock action closed.

Fig. 3

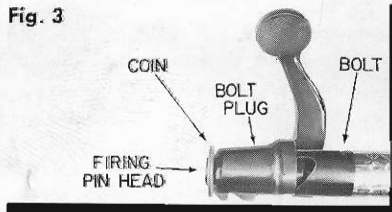

**TO MAGAZINE LOAD** — Open bolt and load cartridges directly into magazine for ADL Grade model.

For BDL Grade, cartridges load in same way or close bolt and load from bottom of magazine. Push safety ON SAFE and turn rifle bottom upwards. Press floor plate latch to release floor plate (Fig. 2). Lift floor plate with attached follower and spring and load cartridges into magazine opening. Close floor plate and snap floor plate into position.

**TO UNLOAD** — Pull bolt rearward carefully and take cartridge from rifle. Then push bolt forward until next cartridge is released from magazine. Continue until magazine is empty. BDL Grade magazine may be unloaded from bottom with bolt closed and safety ON SAFE. Be certain also to empty chamber.

**CAUTION:** Open action and check shell chamber in breech of barrel and magazine to make sure no rounds remain in rifle.

**BARREL CARE** — Use lightly oiled patch, cleaning from breech to muzzle. Remove bolt to make cleaning easier. Press upwards on bolt stop release (Fig. 2) and pull bolt from receiver. Scrub bore with cleaning solvent if necessary.

**ACTION CARE AND DISASSEMBLY** — Remove bolt and stock if necessary to clean action or replace parts. Unscrew, remove guard screws, and lift stock away from action and barrel. Clean bolt and action in solvent and wipe clean.

Before re-assembling stock to receiver, particularly on AL grade, locate magazine fully into magazine recess in bottom of receiver. This special care will prevent any damage to stock when stock is tightened against receiver.

**Note:** Re-assemble BDL Grade trigger guard assembly (includes floor plate, guard, magazine follower and spring) to stock before placing stock over assembled magazine.

**TO DISASSEMBLE BOLT PARTS** — Remove bolt and insert coin or similar piece in slot at rear of firing pin head (Fig. 3). Hold bolt handle and turn bolt plug until firing pin assembly can be unscrewed and removed from bolt assembly. Reassemble in reverse order.

**TO ADJUST TRIGGER** — Remove trigger guard and stock. Cock bolt in receiver.

**IMPORTANT:** No adjustment or removal of the trigger engagement screw is recommended unless replacement is necessary. The trigger engagement screw is set at the factory to engage the trigger and provide the correct amount of supporting trigger connector surface beneath the sear (Fig. 4).

**PULL OF TRIGGER:** Is adjusted to the desired weight by turning the trigger adjusting screw clockwise for a heavier weight adjustment and counter clockwise for a lighter weight adjustment.

**TRAVEL OF TRIGGER:** May be reduced by turning the trigger stop screw clockwise until the firing pin will not fall when the trigger is pulled. Then while keeping pressure on the trigger, back off the trigger stop screw, counter clockwise, until the firing pin falls. Continue back off about  $\frac{1}{16}$  turn. This method of adjusting will allow the least amount of trigger overtravel.

**THE REMINGTON MODEL 700** is a high quality bolt action repeater available in a wide variety of center fire calibers. Two grades are supplied . . . ADL (Standard) and BDL.

Both grades offer a superbly balanced, full length stock with the added comfort of a cheekpiece and Monte Carlo comb. A fore-end tip, grip cap and attractive white spacers accentuate the BDL. Fine custom checkering has been applied to both grades and the entire stock has been protected and beautified by the super tough Du Pont RK-W finish. A sling strap, complete with quick release swivels, is standard equipment on BDL grades.

The Remington Model 700 Varmint is an extremely accurate rifle expressly designed to handle the high velocity "Varmint" calibers. In addition to the Model 700 BDL grade items, this rifle features a heavy-weight, target-type barrel, equipped with front and rear bases for top mounting of telescope sights for long range varmint or target shooting. Tapped holes are provided in the receiver for sight mountings. These holes are filled with receiver plug screws. The conventional iron type front sight has been eliminated to prevent interference with telescope sighting and to provide a clean appearing barrel.

**TO PUT BOLT IN RIFLE** — Simply align bolt lugs to receiver properly, then push cocked bolt forward into rifle.

700  
ADL  
Shown

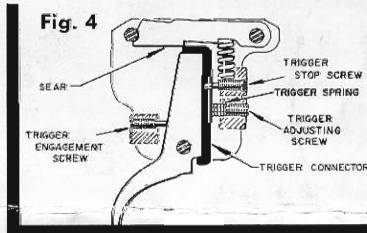
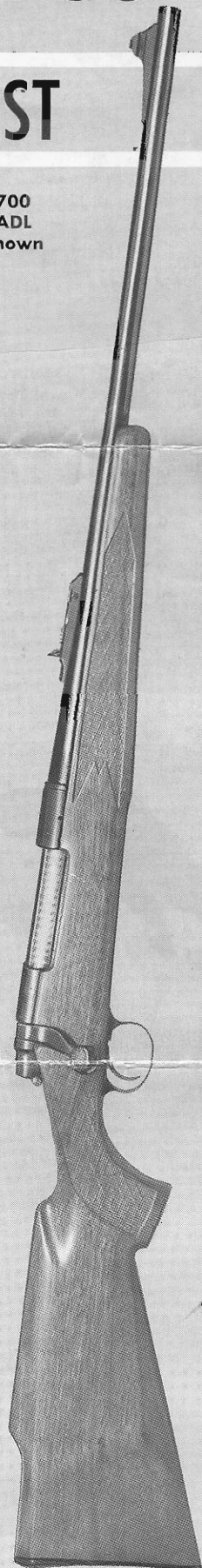

Fig. 4



Your **REMINGTON MODEL 700** will remain clean longer if little or no oil is used on action parts. Lubricate cam surfaces on bolt to prevent wear. Wash action and bolt parts with a good grade of petroleum solvent, dry, and re-oil very lightly.

**HANDLING** — Wipe barrel, receiver, and all steel parts to prevent rusting. Invisible "prints" of moisture can cause rust unless removed.

**EXPOSURE** — After using in wet weather always wipe steel parts with oil to prevent rusting. Abrupt changes in temperature can cause condensation and wetness. Therefore, special care is needed to interior steel parts to prevent rust. When shooting in freezing weather, remove excess oil for best results. Use dry graphite if necessary to lubricate metal parts.

**SIGHT ADJUSTMENT** — Factory sights on Remington high power rifles are targeted at 100 yards and carefully adjusted at factory for average shooters. If your rifle does not appear to shoot accurately it does not necessarily mean that sights are improperly aligned. Individual differences in eyesight or method of shooting may require sight re-alignment. Make sure that adjustable dovetail front sight (where supplied) is centered on barrel. Before attempting

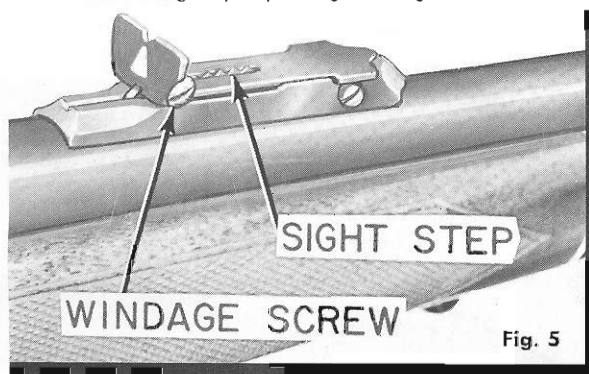

Fig. 5

to re-align sights it should be realized that the greater the group size the more difficult it becomes to determine where rifle is shooting (center of impact). A consistent method of holding rifle, aiming and squeezing trigger will aid in obtaining a small group size. Different sight settings are required for each cartridge type, bullet type and weight, barrel length, each range and wind condition and, most likely, each individual shooter.

To test rifle for accuracy place large target in safe area at desired range. (Before testing at a longer range it is advisable to fire a few rounds at 50 yards. At this range, bullets will generally hit somewhere on target.) Shoot from a prone or sitting position giving body and elbows solid support. Fire four or five shots per group, using ammunition with which you plan to hunt. Shoot carefully and deliberately. If groups are at desired point, sights are correctly adjusted. If not, you should adjust sights (Fig. 5).

If shots are too high, lower rear sight. If shots are too low, rear sight should be raised. If rifle shoots left, rear sight should be moved right by turning windage screw counter clockwise. Should rifle shoot to right, move rear sight to left, turning screw clockwise. Always move rear sight in direction you want rifle to shoot.

Information about trajectory or ballistics of your favorite load may be found in the

Remington Firearms and Ammunition Catalog. A free copy may be obtained from Remington dealers or by writing to Remington Arms Co., Inc., 939 Barnum Ave., Bridgeport, Conn. 06600.

**TELESCOPE OR RECEIVER SIGHTS** — The all-purpose stock on the Remington 700 is adapted for use with telescope or receiver sights as well as gun factory sights. The receiver is drilled and tapped also for telescope and receiver sights. The location and design of the rear sight holes are standard for most target telescope mounts. If rear sight is removed for receiver sighting clearance, the rear sight barrel screw holes may be filled with the receiver plug screws. Front sight ramp may also be removed and receiver plug screws used at muzzle.

**SLING STRAP** — A sling strap complete with mountings is packaged with each BDL Grade rifle. When attaching to rifle — assemble both quick detachable (Q.D.) swivel assemblies to stock. To do this, push plunger on swivel until small plate lifts and can be swung free of attaching stud on swivel. Then insert attaching stud into eye of stock screw. Close plate on swivel to lock swivel to stock screw.

To attach strap to swivels — insert tongue of strap into rear swivel. Loop strap back and thru attached keeper band. Insert strap into and thru buckle and front swivel. Loop back and secure with brass fastener. Adjust strap to desired position.

To remove strap from rifle, simply snap quick detachable swivels from stock screws and remove strap.

This Remington rifle has been designed to satisfy your fullest expectations for excellence. Quality materials and sound manufacturing practices went into the making of this gun. The receiver was expertly milled and finish cut to design specifications. The barrel was forged and rifled by skilled barrel makers. The coloring vats have added a dense gun metal coating to metal parts.

Stock and forearm have been fully seasoned in wood kilns, then shaped by experienced wood workers. A durable and long lasting wood finish has been applied to bring out the natural wood grain. All parts have been carefully assembled to make a strong and smooth working action. Finally, gallery testing in shooting butts and at the range have certified that a fine rifle has been produced for your shooting pleasure and lasting satisfaction.

**MAINTENANCE** — Rifle should be checked periodically by a competent gunsmith to ensure proper inspection and any necessary replacement of worn or damaged parts.

## MODEL 700

### BOLT ACTION—HIGH POWER RIFLE

Notice: Prices for barrels and bolts will be quoted upon application. Factory assembly required.

**When ordering parts—Model No., Part No. and Part Name must be given.**

View No.	Part No.	NAME OF PART	List Price	View No.	Part No.	NAME OF PART	List Price
NOTE: Basic 30-06 Caliber listed below, See Sectional View for proper identity of parts. See added page for other caliber part listings.				38	16454	Rear Sight Base .....	\$ .90
				39	16023	Rear Sight Base Screw .....	.25
1	26271	Barrel Assembly (includes Barrel, Barrel Bracket, Receiver) .....	} Price on Application	40	16456	Rear Sight Screw .....	.25
2	26327	Bolt Assembly (includes Bolt Body Assembly and Bolt Handle) .....		41	28095	Rear Sight Step (Selected Sizes) .....	.25
	26317	Bolt Final Assembly (includes Bolt Assembly, Ejector, Ejector Pin, Ejector Spring, Extractor, Extractor Rivet, Firing Pin Assembly) .....		42	16968	Rear Sight Washer .....	.25
3	17012	Bolt Plug .....	\$ 1.80	43	15358	Rear Swivel Screw, BDL Grade .....	.60
4	17013	Bolt Stop .....	.60	44	17034	Receiver Plug Screw .....	.25
5	24475	Bolt Stop Pin .....	.25	45	26585	Safety Assembly (includes Safety, Safety Button) .....	1.20
6	15478	Bolt Stop Release .....	.25	46	23222	Safety Detent Ball .....	.25
7	17014	Bolt Stop Spring .....	.35	47	15368	Safety Detent Spring .....	.25
8	14472	Butt Plate .....	1.10	48	17043	Safety Pivot Pin .....	.25
9	25410	Butt Plate Screw .....	.25	49	17044	Safety Snap Washer .....	.25
10	15287	Center Guard Screw, ADL Grade .....	.25	50	15666	Sear Safety Cam .....	.60
11	17017	Ejector .....	.90	51	24476	Sear Pin .....	.25
12	17676	Ejector Pin .....	.25	52	17047	Sear Spring .....	.25
13	17019	Ejector Spring .....	.25	53	30855	Sling Strap Assembly, BDL Grade (includes Sling Strap, Fastener, Keeper, Buckle) .....	3.45
14	16254	Extractor .....	1.35		26990	Sling Strap Assembly and Mountings Complete (includes Sling Strap Assembly, Swivel Assembly, Q. D. (2), Front Swivel Nut, Front Swivel Screws, Rear Swivel Screw) .....	9.10
15	27340	Extractor Rivet .....	.25	54	26381	Stock Assembly, ADL Grade (includes Butt Plate, Butt Plate Screw (2), Front Guard Screw Bushing, Stock, Stock Reinforcing Screw, Stock Reinforcing Screw Dowel) .....	38.50
	15376	Fastener, Sling Strap .....	.25		26401	Stock Assembly, BDL Grade (includes Butt Plate, Butt Plate Screw (2), Fore-end Tip, Fore-end Tip Spacer, Grip Cap, Grip Cap Spacer, Front Swivel Nut, Stock, Stock Reinforcing Screw, Stock Reinforcing Screw Dowel) (not shown) .....	44.20
16	22020	Firing Pin .....	2.70		18186	Stock Reinforcing Screw (not shown) .....	.35
17	22040	Firing Pin Assembly (includes Bolt Plug, Firing Pin, Firing Pin Cross Pin, Firing Pin Head, Main Spring) .....	7.50		16970	Stock Reinforcing Screw Dowel (not shown) .....	.25
18	17022	Firing Pin Cross Pin .....	.25	55	26555	Swivel Assembly, BDL Grade (Q. D.) .....	2.10
19	19800	Floor Plate, BDL Grade .....	2.10	56	15280	Trigger .....	.90
20	15291	Floor Plate Latch, BDL Grade .....	.60	57	17053	Trigger Adjusting Screw .....	.25
21	16451	Floor Plate Latch Pin, BDL Grade .....	.25		26345	Trigger Assembly (includes Bolt Stop Release, Trigger Housing Assembly, Safety Assembly, Safety Detent Ball, Safety Detent Spring, Safety Pivot Pin, Safety Snap Washer, Sear and Safety Cam Assembly, Sear Spring, Trigger, Trigger Adjusting Screw, Trigger Connector, Trigger Engagement Screw, Trigger Pin, Trigger Spring, Trigger Stop Screw) (not shown) .....	10.50
22	16452	Floor Plate Latch Spring, BDL Grade .....	.35	58	19461	Trigger Connector .....	.50
23	16453	Floor Plate Pivot Pin, BDL Grade .....	.35	57	17053	Trigger Engagement Screw .....	.25
24	22035	Front Guard Screw .....	.25	59	15281	Trigger Guard .....	2.70
25	15161	Front Guard Screw Bushing, ADL Grade .....	.35	60	26376	Trigger Guard, BDL Grade .....	6.00
26	15373	Front Sight .....	.90		26371	Trigger Guard Assembly, BDL Grade (includes Floor Plate, Floor Plate Latch, Floor Plate Latch Pin, Floor Plate Latch Spring, Floor Plate Pivot Pin, Trigger Guard) (not shown) .....	7.50
	15719	Front Sight (Low) .....	.90	61	26655	Trigger Housing Assembly (includes Trigger Housing Spacer (3), Trigger Side Plate (2) .....	5.25
27	28510	Front Sight Ramp .....	1.50	62	24477	Trigger Pin .....	.25
	15635	Front Sight Ramp, BDL Grade .....	.25	63	15400	Trigger Spring .....	.25
28	28505	Front Sight Ramp Screw .....	.60	64	15481	Trigger Stop Screw .....	.25
29	15363	Front Sight Hood, BDL Grade .....	.25				
30	15357	Front Swivel Nut, BDL Grade .....	.60				
31	15356	Front Swivel Screw, BDL Grade .....	.35				
	15331	Grip Cap, BDL Grade (not shown) .....	.25				
	30505	Grip Cap Spacer, BDL Grade (not shown) .....	.80				
32	15284	Magazine, ADL Grade .....	.60				
	16430	Magazine, BDL Grade (not shown) .....	.25				
33	17024	Magazine Follower .....	.60				
	15752	Magazine Follower, BDL Grade .....	.80				
	15940	Magazine Tab Screw (ADL Grade) .....	.80				
34	17028	Magazine Spring .....	.50				
	15677	Magazine Spring, BDL Grade .....	.25				
35	17029	Main Spring .....	3.30				
36	26355	Rear Guard Screw .....					
37	24525	Rear Sight Assembly (includes Rear Sight Collar, Rear Sight Eyepiece, Rear Sight Leaf, Rear Sight Windage Screw) .....					

**BOLT ACTION—HIGH POWER RIFLE  
INCLUDES VARMINT MODEL**

**MODEL  
700**

Note: Caliber part numbers not listed below same as 30-06  
(222 Rem. Mag. discontinued)

Part No.	NAME OF PART	List Price	Part No.	NAME OF PART	List Price
26272	Barrel Assembly, 7mm Rem. Mag. ....	} Price on Application	15698	Magazine Spring, 22-250 Rem. ....	.80
26274	Barrel Assembly, 6mm Rem. Mag. ....		15699	Magazine Spring, 22-250 Rem., 6mm Rem., 243 Win., BDL Grade ....	.80
26273	Barrel Assembly, 264 Win. Mag. ....		17058	Main Spring, 222 Rem., 222 Rem. Mag., 223 Rem., 243 Win., 308 Win., 6.5mm Rem. Mag., 350 Rem. Mag. ....	.50
26265	Barrel Assembly, 222 Rem. ....		18843	Rear Scope Base, Varmint ....	2.75
26266	Barrel Assembly, 222 Rem. Mag. ....		21387	Recoil Pad, 7mm Rem. Mag., 264 & 300 Win. Mag. ....	3.75
26267	Barrel Assembly, 243 Win. ....		25410	Recoil Pad Screw, 7mm Rem. Mag., 264 & 300 Win. Mag. ....	.25
27675	Barrel Assembly, 300 Win. Mag. ....		18842	Scope Base Screw, Rear, Varmint ....	.25
26268	Barrel Assembly, 308 Win. ....		16205	Scope Base Screw, Front, Varmint ....	.25
26269	Barrel Assembly, 270 Win. ....		26382	Stock Assembly, 7mm Rem. Mag., 264 Win. Mag., ADL Grade (includes Front Guard Screw Bushing, Recoil Pad, Recoil Pad Screw (2), Stock, Stock Reinforcing Screw, Stock Reinforcing Screw Dowel) ....	46.00
27678	Barrel Assembly, 22-250 Rem. ....		26380	Stock Assembly, 222 Rem., 222 Rem. Mag., 243 Win., 308 Win., 6mm Rem., 22-250 Rem., ADL Grade ....	38.50
27676	Barrel Assembly, 6.5mm Rem. Mag. ....		26415	Stock Assembly, 7mm Rem. Mag., 264-300 Win. Mag., BDL Grade (includes Fore-End, Fore-End Spacer, Grip Cap, Grip Cap Spacer, Recoil Pad, Recoil Pad Screw (2), Front Swivel Nut, Stock, Stock Reinforcing Screw, Stock Reinforcing Screw Dowel) ....	51.70
27677	Barrel Assembly, 350 Rem. Mag. ....		26400	Stock Assembly, 222 Rem., 222 Rem. Mag., 243 Win., 308 Win., 6mm Rem., 22-250 Rem., BDL Grade ....	44.20
29570	Barrel Assembly, Varmint, 222 Rem. (includes Barrel, Barrel Bracket, Receiver) ....		29585	Stock Assembly, Varmint, BDL Grade (includes Butt Plate, Butt Plate Screw (2), Fore-End, Fore-End Spacer, Grip Cap, Grip Cap Spacer, Front Swivel Nut, Stock, Stock Reinforcing Screw, Stock Reinforcing Screw Dowel) ....	44.20
29571	Barrel Assembly, Varmint, 22-250 Rem. ....		26402	Stock Assembly, 6.5mm Rem. Mag., 350 Rem. Mag. (includes Fore-End Spacer, Fore-End Tip, Front Swivel Nut, Grip Cap, Grip Cap Spacer, Recoil Pad, Recoil Pad Screw (2), Stock) ....	51.70
29572	Barrel Assembly, Varmint, 223 Rem. ....		26375	Trigger Guard, BDL Grade, 222 Rem., 222 Rem. Mag., 223 Rem., 243 & 308 Win., 6mm Rem., 22-250 Rem. ....	6.00
29573	Barrel Assembly, Varmint, 6mm Rem. ....		26370	Trigger Guard Assembly, BDL Grade, 222 Rem., 222 Rem. Mag., 223 Rem., 243 Win., 308 Win., 6mm Rem., 22-250 Rem., 6.5mm Rem. Mag., 350 Rem. Mag. (includes same as 30-06 BDL Grade) ....	7.50
29574	Barrel Assembly, Varmint, 243 Win. ....		<b>CALIBERS: 375 H&amp;H Magnum, 458 WIN. MAGNUM</b>		
26328	Bolt Assembly, 7mm Rem. Mag., 264 & 300 Win. Mag. ....		27265	Barrel Assembly, 375 H&H Mag. ....	Price on Application
26329	Bolt Assembly, 6.5mm Rem. Mag., 350 Rem. Mag. ....		27266	Barrel Assembly, 458 Win. Mag. ....	Price on Application
26325	Bolt Assembly, 222 Rem., 223 Rem., 222 Rem. Mag. ....		15709	Extractor ....	1.20
26326	Bolt Assembly, 243 Win., 308 Win., 6mm Rem., 22-250 Rem. ....	16771	Front Sight, 375 H&H Mag. ....	.60	
26318	Bolt Final Assembly, 7mm Rem. Mag., 264 & 300 Win. Mag. (includes same as 30-06) ....	23805	Front Sight, 458 Win. Mag. ....	.70	
26319	Bolt Final Assembly, 6.5mm Rem. Mag., 350 Rem. Mag. ....	27270	Stock Assembly, 375 H&H Mag., 458 Win. Mag. (includes same as standard Magnum except Stock Bolt (2), Nut (2), Cover (4) used) ....	Price on Application	
26315	Bolt Final Assembly, 222 Rem., 223 Rem., 222 Rem. Mag. ....	<b>DISCONTINUED or SERVICE PARTS</b>			
26316	Bolt Final Assembly, 243 Win., 308 Win., 6mm Rem., 22-250 Rem. ....	26270	Barrel Assembly, 280 Rem. ....	Price on Application	
15852	Ejector, 222 Rem., 223 Rem., 223 Rem. Mag. ....	20467	Extractor, 222 Cal. ....	1.35	
15709	Extractor, 7mm Rem. Mag., 264-300 Win. Mag., 6.5mm Rem. Mag., 350 Rem. Mag. ....	17639	Ejector, 222 Cal. ....	.90	
15850	Extractor, 222 Rem., 223 Rem., 222 Rem. Mag. ....	16717	Front Sight Ramp, 6mm Rem., 7mm Rem. Mag., 264 Win. Mag., 222 Rem., 222 Rem. Mag., 243 Win., ADL Grade ....	.90	
27341	Extractor Rivet, 7mm Rem. Mag., 264-300 Win. Mag., 6.5mm Rem. Mag., 350 Rem. Mag. ....	15361	Front Sight Ramp, 7mm Rem. Mag., 264 Win. Mag., 222 Rem., 222 Rem. Mag., 243 Win., BDL Grade ....	1.50	
27342	Extractor Rivet, 222 Rem., 223 Rem., 222 Rem. Mag. ....	24666	Front Sight Ramp, 30-06, 280 Rem., 308 Win., 270 Win., ADL Grade ....	.90	
22021	Firing Pin, 222 Rem., 222 Rem. Mag., 243-308 Win., 6mm Rem. Mag., 22-250 Rem., 6.5 mm Rem. Mag., 350 Rem. Mag., 223 Rem. ....	24477	Front Sight Ramp Pin, 6mm Rem., 7mm Rem. Mag., 264 Win. Mag., 222 Rem., 222 Rem. Mag., 243 Win. ....	.25	
22041	Firing Pin Assembly, 222 Rem., 222 Rem. Mag., 243 Win., 308 Win., 6mm Rem., 22-250 Rem., 6.5mm Rem. Mag., 350 Rem. Mag., 223 Rem. ....	19025	Front Sight Ramp Screw, 7mm Rem. Mag., 6mm Rem., 264 Win. Mag., 222 Rem., 222 Rem. Mag., 243 Win. ....	.25	
16434	Floor Plate, BDL Grade, 222 Rem., 222 Rem. Mag., 223 Rem., 243 & 308 Win., 6mm Rem., 22-250 Rem. ....	28200	Rear Sight Assembly, Complete (includes Rear Sight Assembly, Rear Sight Base, Rear Sight Base Screw (2), Rear Sight Screw, Rear Sight Step, Rear Sight Washer (2) ....	5.70	
22037	Front Guard Screw, 222 Rem., 222 Rem. Mag., 223 Rem., 243 & 308 Win., 6mm Rem., 22-250 Rem. ....				
16204	Front Scope Base, Varmint ....				
14659	Front Sight, 7mm Rem. Mag., 264 Win. Mag. ....				
15282	Magazine, ADL Grade, 222 Rem., 222 Rem. Mag. ....				
16716	Magazine, BDL Grade, 222 Rem., 222 Rem. Mag., 223 Rem. ....				
15283	Magazine, ADL Grade, 243 & 308 Win., 6mm Rem., 22-250 Rem. ....				
16715	Magazine, BDL Grade, 243 & 308 Win., 6mm Rem., 22-250 Rem. ....				
14756	Magazine, BDL Grade, 6.5mm Rem. Mag., 350 Rem. Mag. ....				
17975	Magazine Follower, 222 Rem. ....				
16793	Magazine Follower, 222 Rem. Mag. ....				
17056	Magazine Follower, 243 & 308 Win., 6mm Rem., 22-250 Rem., 6.5mm Rem. Mag., 350 Rem. Mag. ....				
15285	Magazine Spacer, 222 Rem. ....				
16826	Magazine Spacer, 222 Rem., BDL Grade ....				
15286	Magazine Spacer, 222 Rem. Mag., 223 Rem., BDL Grade ....				
15742	Magazine Spacer, 222 Rem. Mag., ADL Grade ....				
17983	Magazine Spring, 222 Rem., 222 Rem. Mag., 223 Rem. ....				
17891	Magazine Spring, 243 & 308 Win., 6mm Rem., 6.5mm Rem. Mag., 350 Rem. Mag., ADL Grade ....				

Send all guns for factory service and inquiries on service and parts to

**REMINGTON ARMS COMPANY, INC.**  
Arms Service Division  
Ilion, New York 13357

All other inquiries are to be addressed to  
**REMINGTON ARMS COMPANY, INC.**  
Bridgeport, Connecticut 06602

**MODEL**  
**700**

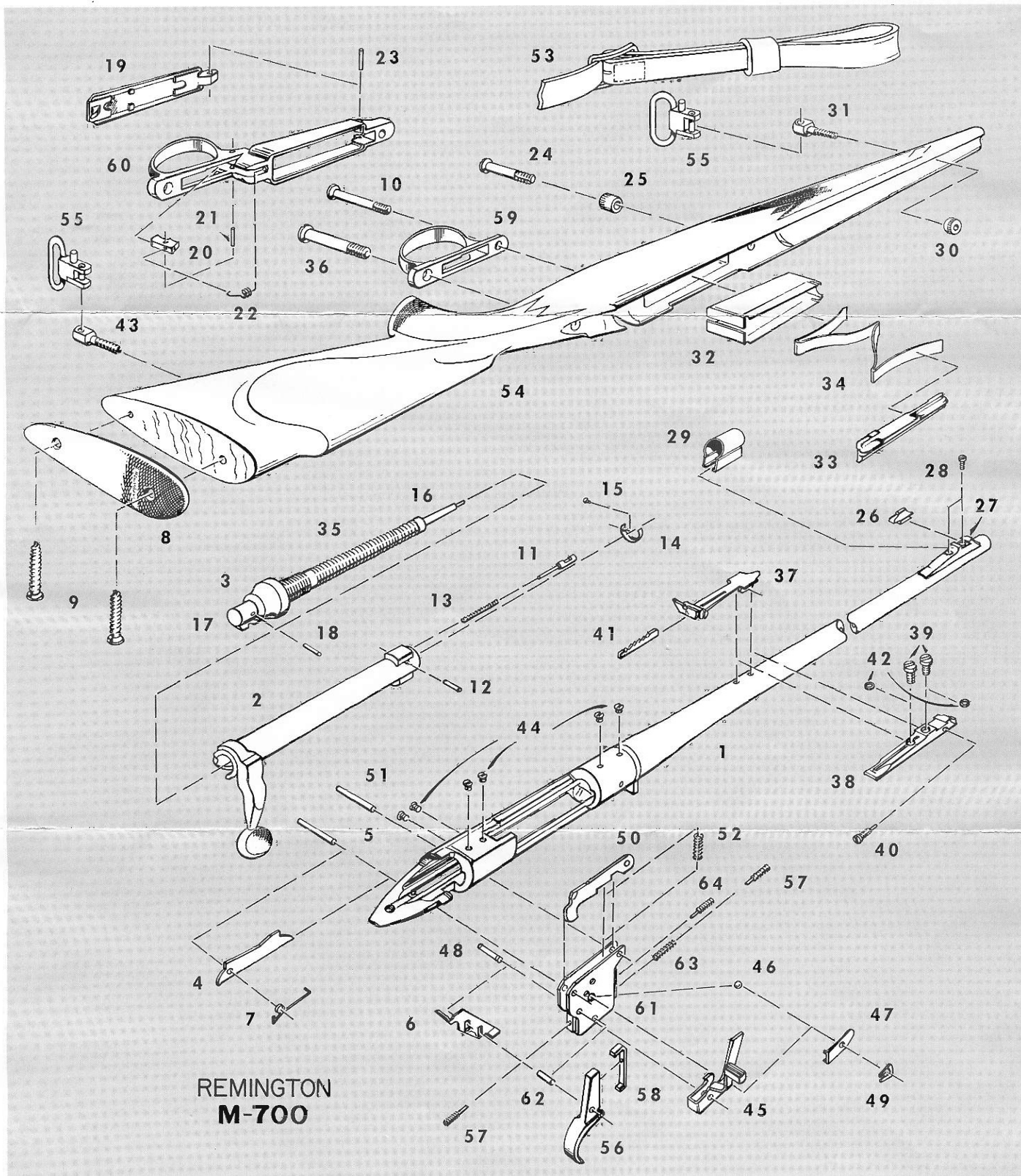

**REMINGTON**  
**M-700**

### REPLACEMENT PARTS

When ordering parts specify model, caliber, part name and serial number of the gun.

**NOTE:** The sale of barrel assemblies and breech bolts is restricted. When these parts are needed for replacement, the arm must be returned to the

factory as the use of special tools and gauges is required to assure proper operation. All other parts will be shipped as ordered but, since they are made to close dimensions, the particular part may require slight adjustment or fitting to assure proper functioning of the arm.

# INSTRUCTIONS FOR ORDERING PARTS

(Please read carefully)

**WHEN ORDERING PARTS . . . MODEL NUMBER, PART NUMBER and PART NAME MUST BE GIVEN.** Give also serial number (if any), and state caliber or gauge and choke needed. Please identify from the component parts, picture or section view. When ordering interchangeable shotgun barrels, please list on separate order form. This will speed up shipment to you.

Cover only one subject in letter or order. Do not order spare parts and give instructions on repair of a gun or guns in the same letter — **this delays service.**

Please **do not ship sample parts** to Firearms Factory unless it is impossible to identify from the Parts List or Instruction Folder. See shipping instructions concerning **FACTORY SERVICE.**

Parts will be furnished for discontinued models as long as the supply is available. We are unable to supply parts for models or repair guns not listed in Complete Line Parts List.

The sale of the following parts and certain other parts is restricted because special tools and gauges are required during assembly to make sure the firearm will operate properly.

• Barrel • Breech Block or Bolt • Receiver

The sale of barrels and bolts is restricted. Special tools, and gauges are required for assembly.

All parts will be shipped as ordered, but since they are made to close dimensions, the particular part may require slight adjustment or fitting to assure proper functioning of the arm.

**IMPORTANT: Do not combine Part Orders with Gun Service Orders.**

Please send Part Orders direct to:

**REMINGTON ARMS COMPANY, INC.**  
**PARTS DEPT.**  
**ARMS SERVICE DIVISION**  
**Ilion, New York 13357**

# INSTRUCTIONS FOR FACTORY SERVICE

**Please read carefully before making shipment to the Firearms Plant at ILION, NEW YORK 13357**

Please package carefully when shipping firearms to factory. Use plenty of cushioning material to prevent movement of gun or gun parts in package during transit.

Please do not ship gun in a gun case, or special container that must be returned from the factory. The return of your gun or parts will be greatly speeded if properly packaged in a throw-away carton.

All shipments should have forwarding and return address clearly marked on gun package as well as on attached letter.

To further improve service — please attach complete letter of information securely on outside of each package returned to the factory for repairs.

Please do not return gun accessories such as sling straps, quick release swivels, special boots, covers, telescopes, mounts or any special equipment to the factory with the gun shipment.

Give full details of the contents of the shipment — state whether complete gun or part. List model name and model number, serial number (if any), and caliber or gauge.

Give full condition of contents — stock and fore-end damage (if any), metal damage (if any), barrel bent or damaged (if any), parts missing, etc. A full description will enable us to more accurately list the needed repairs.

Cover only **one subject** in letter or order. **Do not order spare parts**

and give instructions on repair of a gun or guns in the same letter — **this delays service.**

**THEN** — to avoid all possible delay in starting work on your gun or parts, please include in your first order or letter the trouble you wish corrected, any changes you desire, or parts you wish replaced.

If an estimate is required before the work is started, please advise. Otherwise we will proceed with the necessary work and send a statement of the cost to you. In this manner your gun or parts can be reshipped at the earliest possible date.

Unless you specify otherwise, shipments will be made by way of Parcel Post on small packages, Express on larger packages.

Remington gun parts are not interchangeable with those of any other make of gun. For this reason the Remington Arms Company, Inc. cannot service any gun not of our manufacture.

Repairs will be made on discontinued models as long as the supply of parts is available. However, **repairs cannot be made for models which are not listed in Complete Line Parts List.**

**IMPORTANT: Before packaging guns for return to factory, ALL LIVE AMMUNITION SHOULD BE REMOVED.**

If live ammunition is included in package, shipment cannot be made by Insured Mail. All other shipments may be made by Insured Mail, Express, Motor Transport, or Freight.

Please send repairs direct to:

**REMINGTON ARMS COMPANY, INC.**  
**ARMS SERVICE DIVISION**  
**Ilion, New York 13357**