



# HI-STANDARD REVOLVER



## PARTS PRICE LIST—.22 CALIBER MODEL "R-100, R-101" "SENTINEL"

NUMBERS ARE ONLY FOR BLUED GUNS — SEE PARTS LIST FOR DELUXE NICKEL

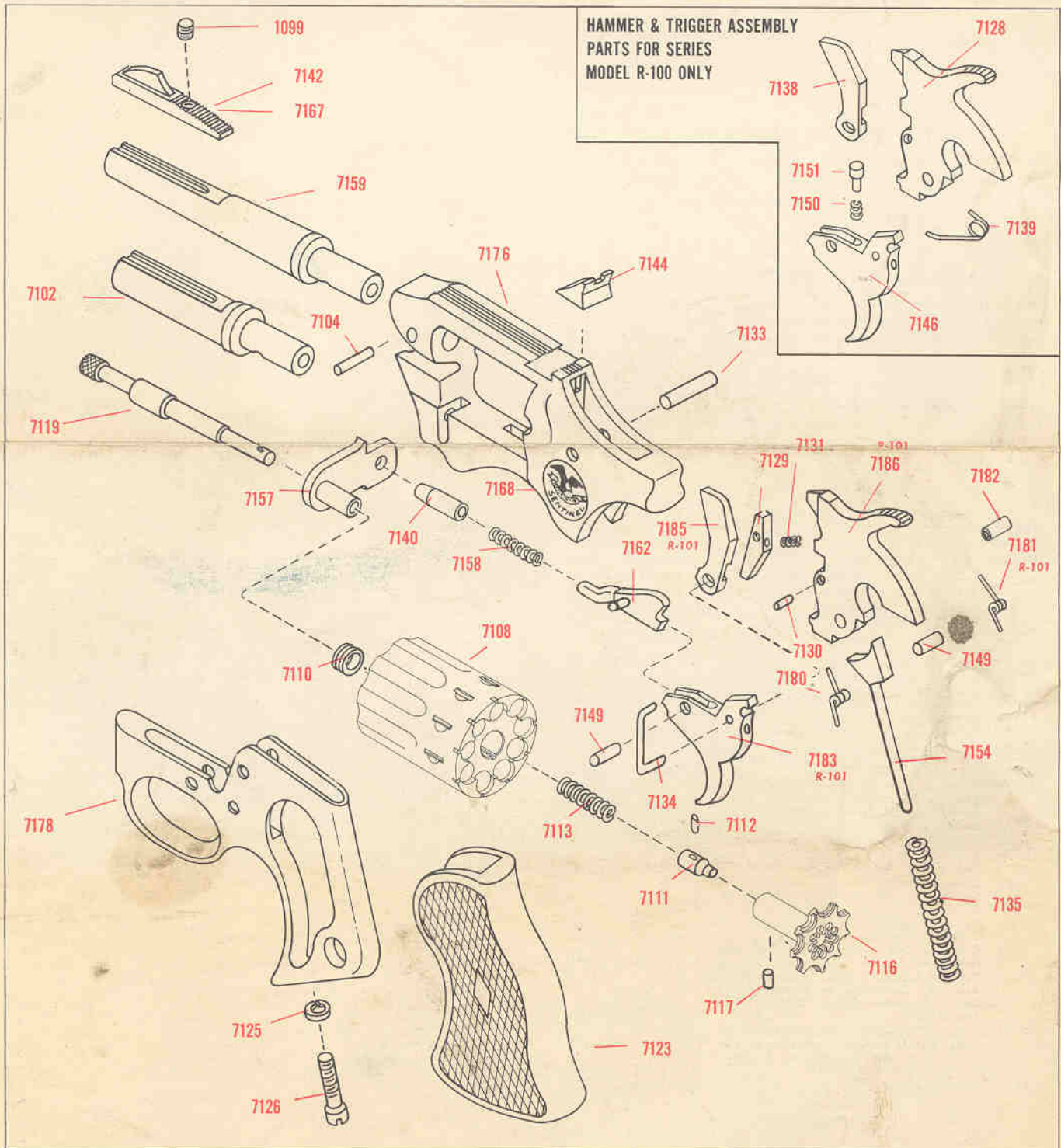

**THE HIGH STANDARD MANUFACTURING CORPORATION**

HAMDEN • CONNECTICUT

# HI-STANDARD

## .22 CALIBER DOUBLE - AND SINGLE- ACTION REVOLVER

### PARTS LIST AND PRICES

(Prices Subject to Change Without Notice)

## "SENTINEL"

MODELS R-100, R-101 BLUED AND DELUXE NICKEL

\* \* \* \* \*

#### HOW TO ORDER REPAIR PARTS

The following information must be furnished when ordering replacement parts:

1. Model Name and Series Number ( R-100, R-101 )
2. Serial Number
3. Number and Name of Parts

#### MINIMUM ORDER \$1.00

Unless advance payment is made, a minimum charge of \$1.00 is made on all orders where the normal cost would be less than \$1.00. Please note also the following paragraph.

#### PAYMENT

All parts shipments will be made by Parcel Post C.O.D. unless advance remittance is made. PLEASE DO NOT SEND CASH OR STAMPS. Checks, Money Orders, or Drafts are acceptable and will save you C.O.D. charges.

#### FACTORY SERVICE

If parts are to be fitted at the factory, send revolver marked for the attention of our SERVICE DEPARTMENT, furnishing complete and specific repair instructions. A cost estimate of the parts and labor charges will be immediately sent for your approval before work is started.

Unless a flat rate charge is specified, a MINIMUM of \$4.50 will be charged on servicing revolver at the factory.

#### REVOLVER SHIPPING INSTRUCTIONS

BONAFIDE DEALERS IN FIREARMS are permitted by postal regulations to send revolvers to the factory by Parcel Post. INDIVIDUALS are not permitted to mail firearms and we recommend shipment by railway express.

All shipments to factory must be prepaid.

| Part Number   | Part Name  | Model        | Price Each |
|---|--|--------------|------------|
| Parts Marked With an Asterisk (*) Must Be Fitted at the Factory |  |              |            |
| *7102   | Barrel, Short (3"), Blued  | R-100, R-101 | \$ 5.00    |
| *7194   | Barrel, Short (3"), Deluxe Nickel  | R-100, R-101 | 5.50       |
| *7169   | Barrel & Sight Assembly, Short (3"), Blued (Includes Front Sight #7194, Front Sight Set Screw #1099)                                       | R-101, R-101 | 6.50       |
| *7215   | Barrel & Sight Assembly, Deluxe Nickel Short (3") (Includes Front Sight #7142, Front Sight Set Screw #1009)                                | R-100, R-101 | 7.00       |
| *7159   | Barrel, Long (6"), Blued   | R-100, R-101 | 6.50       |
| *7195   | Barrel, Long (6"), Deluxe Nickel   | R-100, R-101 | 5.50       |
| *7193   | Barrel & Sight Assembly, Long (6"), Blued (Includes Front Sight #7194, Front Sight Set Screw #1099)  | R-100, R-101 | 6.50       |
| *7216   | Barrel & Sight Assembly, Deluxe Nickel Long (6") (Includes Front Sight #7194, Front Sight Set Screw #1099)                                 | R-100, R-101 | 7.00       |
| 7104  | Barrel Pin, Blued  | R-100, R-101 | .20        |
| 7196  | Barrel Pin Deluxe Nickel   | R-100, R-101 | .30        |
| 7157  | Crane Assembly, Blued (Includes Crane Link #7105, Crane Link Bearing #7107)  | R-100, R-101 | 2.50       |
| 7197  | Crane Assembly Deluxe Nickel (Includes Crane Link #7105, Crane Link Bearing #7107)   | R-100, R-101 | 3.00       |
| 7108  | Cylinder, Blued (Not sold separately. See Cylinder Assembly #7156)   | R-100, R-101 | —          |
| 7198  | Cylinder, Deluxe Nickel (Not sold separately. See Cylinder Assembly #7217)   | R-100, R-101 | —          |
| *7156   | Cylinder Assembly, Blued (Includes Ejector Assembly Consisting of Ejector #7116, Ejector Alignment Dowel #7117, Ejector Rod #7119)         | R-100, R-101 | 12.00      |
| *7217   | Cylinder Assembly, Deluxe Nickel (Includes Ejector Assembly consisting of Ejector #7116, Ejector Alignment Dowel #7117, Ejector Rod #7119) | R-100, R-101 | 14.00      |
| 7110  | Cylinder Bushing   | R-100, R-101 | .30        |

| Part Number | Part Name  | Model        | Price Each |
|-------------|--|--------------|------------|
| 7111        | Cylinder Lock Plunger  | R-100, R-101 | .50        |
| 7112        | Cylinder Lock Plunger  | R-100, R-101 | .20        |
| 7113        | Cylinder Lock Plunger Spring   | R-100, R-101 | .20        |
| 7162        | Cylinder Stop Assembly (Includes Cylinder Stop #7114, Cylinder Stop Cross Pin #7115) | R-100, R-101 | 1.50       |
| 7158        | Cylinder Stop Spring   | R-100, R-101 | .20        |
| 7116        | Ejector (Not sold separately. See Cylinder Assembly #7156)                           | R-100, R-101 | —          |
| 7117        | Ejector Alignment Dowel  | R-100, R-101 | .20        |
| 7119        | Ejector Rod, Blued   | R-100, R-101 | 1.00       |
| 7199        | Ejector Rod, Deluxe Nickel   | R-100, R-101 | 1.50       |
| *7121       | Frame, Blued (Not sold separately)   | R-100        | —          |
| *7156       | Frame, Blued (Not sold separately)   | R-101        | —          |
| *7207       | Frame, Deluxe Nickel (Not sold separately)   | R-100        | —          |
| *7176       | Frame, Deluxe Nickel (Not sold separately)   | R-101        | —          |
| 7123        | Grip (Brown)   | R-100, R-101 | 2.00       |
| 7211        | Grip (White, for Deluxe Nickel)  | R-100, R-101 | 2.85       |
| 7125        | Grip Lockwasher  | R-100, R-101 | .20        |
| 7126        | Grip Screw   | R-100, R-101 | .20        |
| 7128        | Hammer, Cyanide Finish for Blued Revolver  | R-100        | 3.50       |
| 7186        | Hammer, Cyanide Finish for Blued Revolver  | R-101        | 3.50       |
| 7127        | Hammer, Blued for Deluxe Nickel Revolver   | R-100        | 3.50       |
| 7176        | Hammer, Blued for Deluxe Nickel Revolver   | R-101        | 3.50       |
| 7153        | Hammer Assembly (Includes Hammer #7128, Hammer Pawl #7129, Pin #7130, Spring #7131)  | R-100        | 4.50       |
| 7188        | Hammer Assembly (Includes Hammer #7186, Hammer Pawl #7129, Pin #7130, Spring #7131)  | R-101        | 4.50       |

**CAUTION: FOR SAFETY'S SAKE DO NOT ATTEMPT TO REPAIR REVOLVER WITHOUT RECEIVING RELIABLE A**

| Part Number | Part Name   | Model        | Price Each |
|-------------|---|--------------|------------|
| 7152        | Hammer Assembly, Blued for Deluxe Nickel Revolver (Includes Hammer #7127, Hammer Pawl #7129, Pin #7130, Spring #7131) | R-100        | 4.50       |
| 7189        | Hammer Assembly, Blued for Deluxe Nickel Revolver (Includes Hammer #7186, Hammer Pawl #7129, Pin #7130, Spring #7131) | R-101        | 4.50       |
| 7129        | Hammer Pawl   | R-100, R-101 | 1.00       |
| 7130        | Hammer Pawl Pin   | R-100, R-101 | .20        |
| 7131        | Hammer Pawl Spring  | R-100, R-101 | .20        |
| 7133        | Hammer Pivot Pin, Blued   | R-100, R-101 | .20        |
| 7160        | Hammer Pivot Pin (Deluxe Nickel)  | R-100, R-101 | .60        |
| 7134        | Hammer Safety Stop  | R-100, R-101 | .20        |
| 7135        | Hammer Spring   | R-100, R-101 | .20        |
| 7154        | Hammer Spring Guide Assembly (Includes Hammer Spring Guide Head #7136, Spring Guide Pin #7137)                        | R-100, R-101 | 1.00       |
| 7138        | Hand  | R-100        | 1.00       |
| 7185        | Hand  | R-101        | 1.00       |
| 7139        | Hand Spring   | R-100        | .20        |
| 7181        | Hand Spring   | R-101        | .20        |
| 7140        | Link Pivot Pin  | R-100, R-101 | .40        |
| 7168        | Monogram Insert   | R-100        | .50        |
| 7182        | Hammer Sleeve   | R-101        | .12        |
| 7142        | Sight, Front, Short Barrel  | R-100, R-101 | 1.50       |
| 7144        | Sight, Rear   | R-100, R-101 | 1.10       |
| 1099        | Sight Set Screw, Front  | R-100, R-101 | .20        |
| 7167        | Sight, Front Long Barrel  | R-100, R-101 | 1.50       |
| 7146        | Trigger, Cyanide Finish for Blued Revolver  | R-100        | 2.50       |
| 7145        | Trigger, Blued for Deluxe Nickel Revolver   | R-100        | 2.50       |
| 7183        | Trigger, Cyanide Finish for Blued Revolver  | R-101        | 2.50       |
| 7184        | Trigger, Blued for Deluxe Nickel Revolver   | R-101        | 2.50       |
| *7148       | Trigger Guard, Blued  | R-100        | 3.50       |
| *7210       | Trigger Guard, Deluxe Nickel  | R-100        | 4.50       |
| *7178       | Trigger Guard, Blued  | R-101        | 3.50       |

| Part Number | Part Name                    | Model        | Price Each |
|-------------|------------------------------|--------------|------------|
| *7206       | Trigger Guard, Deluxe Nickel | R-101        | 4.50       |
| 7149        | Trigger Pivot Pin            | R-100, R-101 | .20        |
| 7150        | Trigger Spring               | R-100        | .20        |
| 7180        | Trigger Spring               | R-101        | .20        |
| 7151        | Trigger Spring Plunger       | R-100        | .20        |
| 7149        | Trigger Spring Retaining Pin | R-101        | .20        |

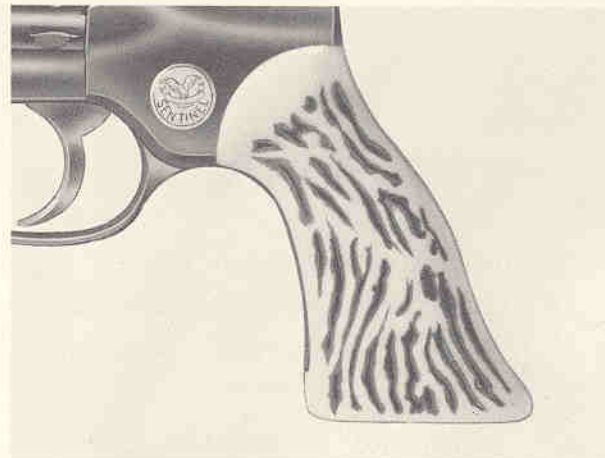

### STAG GRIPS

Add beauty to your Sentinel with Molded Stag Grips. Price ..... \$5.00

## INSTRUCTIONS FOR OPERATION AND CARE OF YOUR "SENTINEL" REVOLVER



Fig. 1

### LOADING AND FIRING:

1. Be sure that hammer is down.
2. Pull ejector rod forward and, at the same time, swing out cylinder to left by pressing right index finger against it (see Figure 1).
3. Insert one .22 caliber short, long or long rifle cartridge in each of the nine chambers of the cylinder.
4. Swing cylinder shut and revolver is ready to fire.
5. Revolver may be fired double action merely by squeezing trigger for each shot.
6. Target shooting, or other shooting demanding a maximum of accuracy, is usually done single action. For single-action shooting, pull back hammer to cocked position for each shot.
7. To unload revolver or remove fired cartridge cases, pull ejector rod forward, swing out cylinder to left (see Figure 1), and push ejector rod to rear (See Figure 2).
8. Pull ejector rod forward before reloading or attempting to close cylinder.

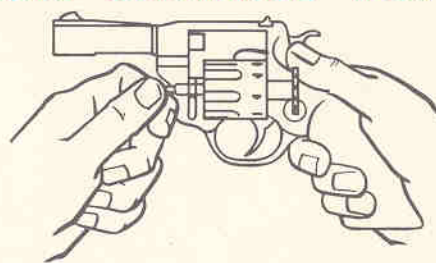
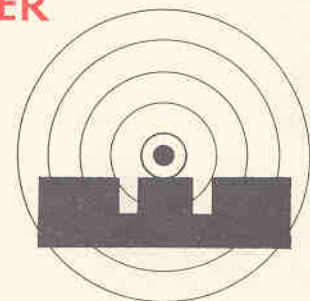

Fig. 2



Correct Sighting

### SIGHT ADJUSTMENT:

Sentinel revolvers are sighted in at a range of 50 feet. If lateral adjustment is desired because of individual preference in sighting or holding, tap the rear sight gently, using a brass or plastic hammer. Move the rear sight in the direction you want the point of impact to move.

# Hi-Standard .22 Caliber Autoloading Pistols

## TARGET & FIELD MODELS

The Hi-Standard family of top performers offers a combination of features not found in other pistols. Made by precision craftsmen, their accuracy is matched only by their handsome appearance.



**Dura-Matic:** The perfect extra gun at a low price. **DEPENDABLE:** Fires .22 long rifle ammunition with good accuracy and performance. **SAFE:** Visible indicator shows when gun is ready to fire; combination slide lock for positive cross-bolt safety. **VERSATILE:** Ideal all-around 10-shot autoloader for campers, hunters, fishermen, plinkers. Choice of 4½" or 6½" barrels at \$37.50; both barrels \$7.50 extra.



**Sport-King:** Hard-hitting .22 long rifle autoloader. **HANDSOME:** A sleek handful of modern handgun. Lightweight model with forged aluminum alloy frame weighs only 27 ounces; steel-frame model 37 ounces. **BALANCED:** Points as naturally as your finger. **IDEAL:** Hunters, trappers, campers, fishermen, plinkers, target shooters all praise this gun. Choice of 4½" or 6¾" barrels at \$43.75; both barrels \$8.00 extra.



**Flite-King:** The gun that pays for itself by saving on ammunition. **ECONOMICAL:** Low first cost and shoots money-saving .22 shorts. **QUIET:** Light report for basement shooting, yet target accuracy for outdoor use. **MODERN:** Lightest American-made .22 autoloader, alloy slide and frame, fast-action take-down. Choice of 4½" or 6¾" barrels at \$43.75; both barrels \$8.00 extra.



**Supermatic:** World famous as the ultimate in .22 long rifle target pistols. **SUPERBLY ACCURATE:** Choice of top target shooters everywhere. Target sights with precise click adjustments for windage and elevation. **STABILIZER BARREL:** Reduces "muzzle jump". **PERFECTLY BALANCED:** Additional adjustable weights for precise "feel" and natural positioning. Choice of 4½" plain barrel, \$71.60; 6¾" stabilizer barrel, \$74.55; combination \$85.55.



**Field-King:** Ideal for targets and field shooting. **EXTRA VALUE:** A .22 long rifle autoloader with features normally found only on higher-priced Hi-Standards — stabilizer barrel, target sights with precise click adjustments for windage and elevation. **TARGET ACCURACY:** Unsurpassed as a medium-weight, medium-priced target pistol. **PERFORMANCE:** A worthy member of the family of top performers. Choice of 4½" plain barrel, \$58.65; 6¾" stabilizer barrel, \$61.65; combination \$70.65.



**Olympic:** A .22 short autoloader with world-wide reputation for target accuracy won in international competition. **SUPERBLY ACCURATE:** Target sights with precise click adjustments for windage and elevation. Choice of top target shooters. **STABILIZER BARREL:** Reduces "muzzle jump". **PERFECTLY BALANCED:** Additional adjustable weights for precise "feel" and natural positioning. Choice of 4½" plain barrel, \$71.60; 6¾" stabilizer barrel, \$74.55; combination \$85.55.