

**Ed Brown
Products®**

2009

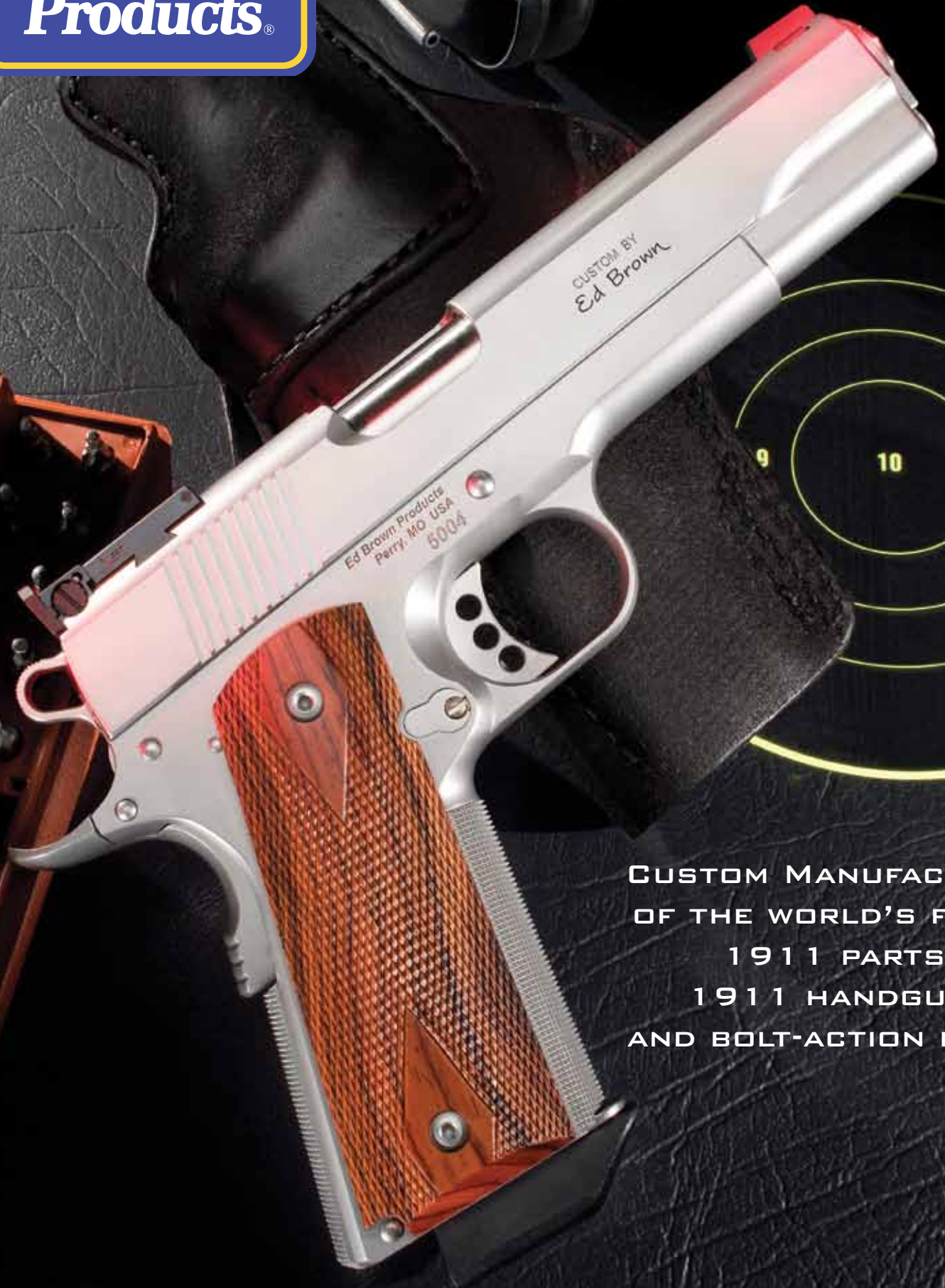

**CUSTOM MANUFACTURER
OF THE WORLD'S FINEST
1911 PARTS,
1911 HANDGUNS,
AND BOLT-ACTION RIFLES**

COMPANY HISTORY

FOR NEARLY 40 YEARS, THE BROWN FAMILY HAS BEEN FAMOUS FOR INNOVATIVE ENGINEERING, PRECISION MANUFACTURING, AND QUALITY HAND CRAFTSMANSHIP IN THE FIREARMS INDUSTRY.

Since 1968, Ed Brown has built his reputation as one of the world's finest custom pistolsmiths, one customer at a time. Ed was named "Pistolsmith of the Year" by his fellow Guild members, a prestigious honor awarded only to those who have shown the highest degree of honesty and craftsmanship in their work. Also an avid competitive shooter, Ed was ranked in the top 16 of the world as a championship combat shooter.

After years of frustration over the second-rate quality of 1911 parts he had to work with, Ed began to envision a full line of quality aftermarket parts of a completely new design. Having been professionally trained as a professional tool and die maker, CNC programmer, and CAD/CAM designer, Ed had the background experience to evolve into a custom manufacturer, and make this dream a reality.

Ed eventually quit his day job to launch his parts business. Within months, it was an astounding success. Ed Brown Products, Inc. incorporated in June of 1992, and in 1998, Ed's two sons, Travis and Wade, joined the business full time. After manufacturing all the major components of the 1911, a new direction was established - the design and manufacture of a complete line of Ed Brown firearms, not only the 1911 but also a proprietary line of bolt-action rifles.

Today, Ed Brown Products, Inc. operates in a state-of-the-art 12,500+ square foot facility. Millions of dollars have been invested in the latest, high-tech CNC equipment which turns forgings and bar stock steel into some of the world's finest firearms. In our Missouri-based facility, this leading edge technology is gracefully combined with traditional, old-world craftsmanship under the direct supervision of the Brown family.

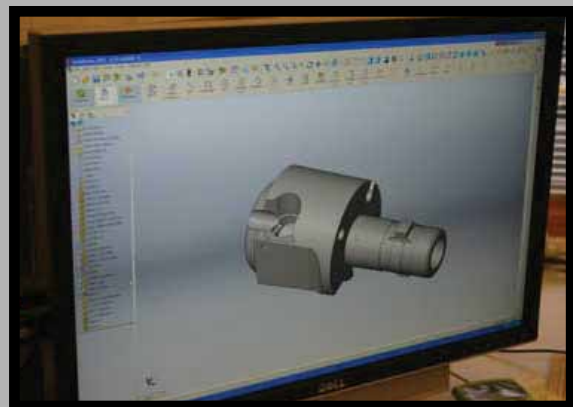

MANUFACTURING PHILOSOPHY

Ed Brown firearms are engineered, manufactured, and handcrafted for performance. At our company, it's all about the product. We strive to make the very best high grade, high performance firearms, at a reasonable price and delivery, using our own innovative designs, superior components, and hand craftsmanship. Our manufacturing philosophy is based on the following three pillars:

ENGINEERING EXCELLENCE

The Brown family is well-known for their innovation and excellence in engineering designs of superior performance. We broke all the rules, and originally conceived and CAD/CAM designed our firearms as complete custom firearms. Every part on our firearms has been redesigned, enhanced, or more closely toleranced for one thing: Performance. Only the finest materials are used to meet our precise engineering specifications.

PRECISION MANUFACTURING

We've invested millions in state-of-the-art CNC manufacturing technology specifically for the firearms industry. Housed inside our 12,500+ square foot facility, are the latest in horizontal machining centers, swiss type turning machines, precision broaching, and fine polishing equipment. It is this investment of resources that has made us one of the leaders in the field, and will keep us at the leading edge in the future. Our components are manufactured in-house on CNC machinery by Ed Brown Products, under direct supervision of the Brown family. This means that we have complete control over the quality and delivery of the final product. None of our competitors can match this claim.

HAND CRAFTSMANSHIP

Often it's the little things that make the difference. The Brown family has built a reputation for the highest degree of hand craftsmanship. We go that extra mile by putting more hand fitting and finishing into our firearms than any other manufacturer, resulting in some of the most attractive firearms available anywhere at any price. Each firearm is carefully finished and inspected by one of the Brown's before it leaves our facility.

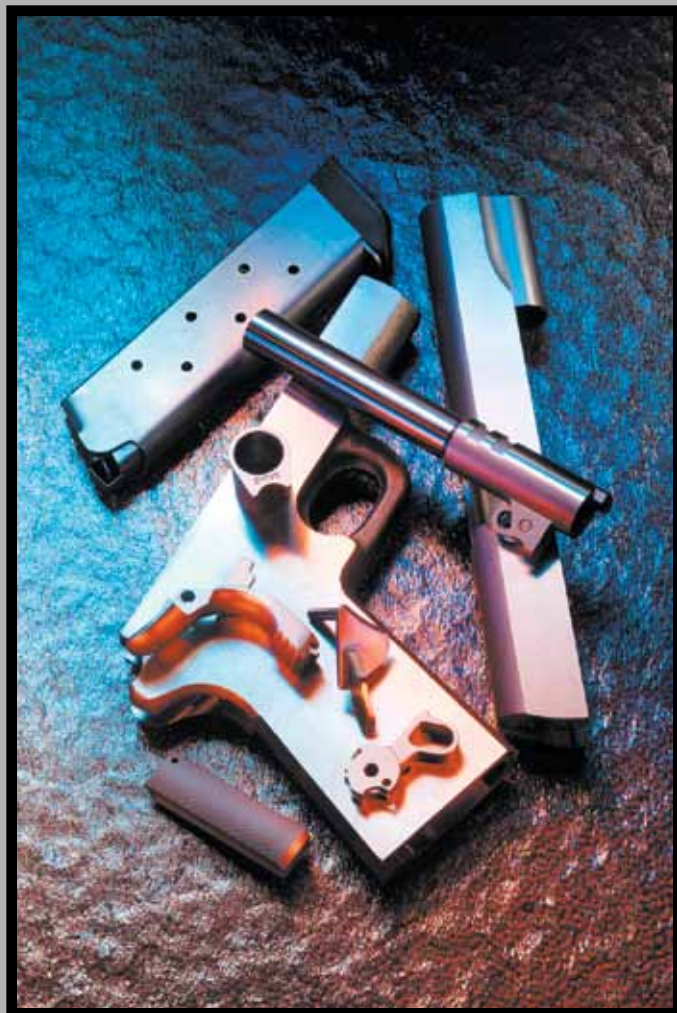

INNOVATION, NOT IMITATION



ED BROWN CUSTOM RIFLES

ENGINEERING EXCELLENCE

It has taken the engineering excellence of Ed Brown to finally successfully blend the advantages of both push feed and conventional controlled feed into one new action - the Model 704. The Ed Brown M704 controlled feed action is the heart of every Ed Brown rifle, and we've developed this entirely new, superior designed action, manufactured in-house. It's completely controlled feed, but without the disadvantages of the long extractor Mauser/Winchester design. Retaining 100% barrel threads, and complete receiver integrity, the M704 offers genuine controlled feed reliability. Plus, it still has a counterbored chamber with bolt partially surrounded by bolt face steel. Our spring loaded extractor is intergral with the bolt, and rotates with it, to position the extractor under the cartridge for full support inside the chamber, thus placing the bullet in a perfect position for its exit.

PRECISION MANUFACTURING

Rigidity directly affects accuracy and strength and comes from using only the best pre heat-treated steel, and keeping it as solid as possible. No skeleton cuts or other weight saving cuts are made which would reduce strength or rigidity.

Concentricity is how centered the bore is with the outside diameter of the tube. During production, the entire action is kept perfectly straight, true and concentric, being held on centers throughout the manufacturing process for the highest accuracy attainable.

Precision: by machining pre heat-treated steel with carbide tooling, we eliminate any distortion and warpage in the components, which is exactly what you get with other factory actions. The critical cuts, such as those on our bolt, are performed in one set-up on complex computerized machinery for perfect timing.

HAND CRAFTSMANSHIP

We start with the Ed Brown M704 custom action and meticulously fit it to a Shilen barrel, which hold world records for accuracy. Our own specially designed and made benchrest quality chamber reamers are used to achieve the highest degree of accuracy attainable. The barrels crowns are deeply countersunk. The barreled action is then hand-bedded for a perfect fit in the world renown McMillan fiberglass stock, which is the strongest, most rigid fiberglass stock available. The stock is painted with industrial quality all-weather paint, which is impervious to solvents and rain. Steel T-nuts are embedded in the swivel studs for strength, and you get a full one inch thick soft Pachmayr recoil pad. Fiberglass stocks (unlike wood) are not affected by weather, temperature, or humidity changes, so the accuracy stays consistent in all types of conditions. The fit and finish are far above the competition. Ed Brown rifles are simply the most accurate and reliable high performance rifles made anywhere at any price.



"I have paid nearly twice as much for high end rifles that aren't as good as the Ed Brown. I've tried them all, and you have the most accurate rifles, period. I'll be a customer for life!"

Robert Adams

TECHNICAL SPECIFICATIONS

- Precision machined from pre heat-treated steel to eliminate warping in heat treat.
- Receiver threads CNC cut with a single point tool for true center and size.
- Outer diameter turned true concentric with bore.
- Hand fitted bolts with welded on handles, fully machined from bar stock.
- Spiral flutes on bolt distribute lubrication, enhance self-cleaning, and allow a tighter fitting bolt.
- No spiral flutes on lower sides of bolt for smoother feeding with belted cartridges.
- Integral machined bolt guide for the ultimate in smoothness and ultra no-bind reliability.
- Hand lapped locking lugs.
- .300" thick heavy duty recoil lug adds rigidity and prevents action flex.
- Benchrest quality chambering, using our own specially ground reamers.
- Deep countersunk barrel crowning for maximum accuracy and durability.
- Exclusive integral controlled feed extractor for the ultimate in feeding reliability.
- Beautifully machined and serrated three position lever safety securely locks bolt down while engaged, yet safety allows unloading while engaged.
- All weather McMillan fiberglass stock, precision bedded with aluminum pillars.
- Easy to operate push-button bolt stop outside the action, above the stock line.
- Machined steel trigger guard and floor plate.
- 3.700 magazine box on long action models.
- 2.850 magazine box on short action models.
- Extremely durable socket head action screws.
- 1" recoil pad with standard 13 3/4" length of pull. Custom pull lengths available in 1/4" increments.
- Sling swivels standard equipment, double front swivels on Tactical models for bipod attachment.
- Full round receiver ring greatly assists scope mounting accuracy.
- Custom scope bases with heavy duty 8-40 screws.
- **All models can be customized, and personalized with laser engraving.**



THE SAVANNA

Our most popular rifle, the Savanna is a superbly accurate medium weight hunting rifle intended for long ranges around the world. A hand laid fiberglass McMillan stock with a tack driving #4 magnum contour barrel offers the long range hunter the tool he needs to make the shots others only dream of, all in an extremely attractive package. Equally at home in Alaska or Africa, the Savanna may be chambered for a wide variety of effective calibers. The Savanna features a classic style stock with a medium width forend, full grip, cheekpiece, and beautiful checkering for a secure grip. This stock has everything a hunter needs to produce the fine accuracy the rifle is known for. Most popular are the 300 Win Mag and 300 Weatherby Mag calibers. A muzzle brake with protective cap is included on magnum models. A lighter weight #3 contour barrels without muzzle brake included on standard calibers.

All Savanna's are built with the following:

- Ed Brown controlled feed action with machined steel trigger guard and hinged floor plate.
- Match grade, hand lapped and precision chambered Shilen barrel in stainless steel with black Gen III coating for superior rust protection.
- Hand-bedded McMillan fiberglass stock. Sporter style with cheek piece, checkering and full 1" thick Pachmayr Decel recoil pad.

The following base models are available in the caliber of your choice:

Base Model	Caliber Groups	Capacity	Barrel Type, Length, Contour	Trigger	Muzzle Brake	Weight
SAVANNA STANDARD	SHORT, LONG	4 + 1	STAINLESS WITH GEN III COATING, 24", #3 CONTOUR	JEWELL	NO	7.5 LBS
SAVANNA MAG	SHORT, LONG, MAG, ULTRA	3 + 1	STAINLESS WITH GEN III COATING, 24", #4 CONTOUR	JEWELL	YES	8 LBS



“Classic styling and superior craftsmanship distinguish this fine, no-nonsense hunting rifle.”

Jon R. Sundra, *Guns Magazine*



THE DAMARA

Our light weight hunting rifle, with an ultra lightweight graphite stock and special barrel contours specifically matched for balance. Graphite is extremely strong and rigid, making for an accurate light weight rifle. Many shooters get confused about choosing a light weight rifle. The lightest you can find certainly isn't "best". Balance is much more important than weight. We don't try to make a super lightweight rifle by compromising safety and accuracy, even though we are certainly capable of it. We feel you need a certain amount of weight, and particularly rigidity, to shoot a rifle accurately, and you need balance most of all. The Damara does not have a butchered action, or a weakened stock, both of which reduce rigidity and compromise safety. The design and weight of the Damara is perfectly positioned between too light and "heavier than necessary."

All Damara's are built with the following:

- Ed Brown controlled feed action with machined steel trigger guard and hinged floor plate.
- Match grade, hand lapped and precision chambered Shilen barrel in stainless steel with black Gen III coating for superior rust protection.
- Hand-bedded ultra light weight McMillan graphite stock, with checkering and full 1" thick Pachmayr Decel recoil pad.

The following base models are available in the caliber of your choice:

Base Model	Caliber Groups	Capacity	Barrel Type, Length, Contour	Trigger	Muzzle Brake	Weight
DAMARA STANDARD	SHORT, LONG	4 + 1	STAINLESS WITH GEN III COATING, 23", #2 CONTOUR	JEWELL	NO	6.2 LBS
DAMARA MAG	SHORT, LONG, MAG, ULTRA	3 + 1	STAINLESS WITH GEN III COATING, 24", #2 CONTOUR	JEWELL	YES	6.9 LBS



Removable muzzle brake substantially reduces recoil



Dall sheep taken by *Sports Afield* Editor Diana Rupp with her Ed Brown Damara

"I could not have asked for a better rifle and scope package. As you are well aware, mountain hunting is tough and equipment has got to be utterly dependable. Your products deliver!"

Michael Hussey, Louisville, KY



THE EXPRESS

The Express is the result of two years of testing prototypes on actual dangerous game hunts. A special dropped box magazine ensures feeding and allows a full four round capacity in the magazine, plus one in the chamber. Our new M704 fully controlled feed action eliminates all the inherent weaknesses of the original long extractor design by incorporating the huge extractor within the bolt. This is the first real advance in controlled feed guns in a hundred years. This new drop box high capacity design required a completely new stock to accommodate it. This new stock is extremely strong around the larger mag box and has a generous recoil pad and butt stock to absorb the recoil these powerful cartridges create. A barrel band is standard for a lower profile when carrying the rifle through heavy brush. All these features work together to furnish you the safest, most accurate, and most comfortable to shoot, large caliber rifle available today.

All Express rifles are built with the following:

- Ed Brown controlled feed action with machined steel trigger guard and hinged floor plate.
- Match grade, hand lapped and precision chambered Shilen barrel in stainless steel with black Gen III coating for superior rust protection.
- Hand-bedded McMillan fiberglass stock. Monte Carlo style with cheek piece and full 1" thick Pachmayr Decel recoil pad.

The following base model is available in the caliber of your choice:

<i>Base Model</i>	<i>Caliber Groups</i>	<i>Capacity</i>	<i>Barrel Type, Length, Contour</i>	<i>Trigger</i>	<i>Muzzle Brake</i>	<i>Weight</i>
EXPRESS	MAG, ULTRA, LARGE MAG	4 + 1	STAINLESS WITH GEN III COATING, 24", #4, ADJUSTABLE IRON SIGHTS, BARREL BAND	SHILEN	NO	9 LBS





MARINE SNIPER

A duplicate of the original Marine sniper rifle developed by McMillan for the Vietnam war, but of much higher quality than the original. Makes a great long range hunting rifle too! All our rifles feature the fully machined three position safety and bolt sleeve that allow unloading on safe, plus the important feature of locking the bolt handle fully down when on safe position. All Marine's are fitted with match quality hand lapped Shilen barrel then precision chambered and crowned.

All Marine Snipers are built with the following:

- Ed Brown controlled feed action with machined steel trigger guard and hinged floor plate.
- Match grade, hand lapped and precision chambered Shilen barrel in stainless steel with black Gen III coating for superior rust protection.
- Hand-bedded McMillan fiberglass stock with special Woodland Camo pattern molded in, not painted. Extremely durable. Checkering and full 1" thick Pachmayr Decel recoil pad.

The following base model is available in the caliber of your choice:

<i>Base Model</i>	<i>Caliber Groups</i>	<i>Capacity</i>	<i>Barrel Type, Length, Contour</i>	<i>Trigger</i>	<i>Muzzle Brake</i>	<i>Weight</i>
MARINE SNIPER	SHORT, LONG, MAG, ULTRA	4 + 1	STAINLESS WITH GEN III COATING, 24", RV	SHILEN	NO	10 LBS



"I just wanted to thank you for building me the most accurate rifle I have ever fired, the 308 Marine Sniper. It will put 5 Federal Gold Medal Match 168 grain into one hole at 100 yards and recoil is negligible. It was a real joy to shoot. I think you are selling your rifles too cheaply! What an incredible bargain! Thank you!"

SGT Peter Tammaro





100 CRIG, 20MM

34-A896

T 92

A5 TACTICAL

The ultimate tactical rifle which incorporates all known technology to produce accuracy and reliability. The A5 Tactical rifle is a precision tool for serious use, but at the same time is a tremendous target rifle. It has the famous McMillan A-5 stock, expressly designed for tactical use and known the world over for its precision. The new A5 stock combines all the most requested features of the entire A-series into one professional tactical rifle stock. The A5 uses a beavertail forearm that is wider and flatter and is better suited to fanny pack use, without giving up anything off sandbags. The forend has an extremely low center of gravity for enhanced stability. The A5 uses the same A-3 pistol grip. The dual purpose hook is fully functional for either riding sandbags or controlling the rifle with the non-trigger hand. Its brilliant design will become apparent with its first use. Every aspect of this rifle is designed for tack driving accuracy. Its heart of course, is our own perfectly true controlled feed M704 receiver fully machined from pre-heat treated bar stock in-house. The barrels are only the finest hand-lapped match quality heavy #7 contour stainless Shilen, and are painstakingly fitted and chambered to the most exacting tolerances in the industry. All critical components of each A5 Tactical are fully machined bar stock steel for maximum durability. Standard equipment is the aluminum trigger guard with a five round detachable box magazine. The A5 may be ordered with a hinged floor plate instead of the magazine if desired. A5's are only available in the calibers listed below with a detachable box. However, with our standard steel floorplate, any calibers from our caliber list may be had.

All A5 Tactical rifles are built with the following:

- Ed Brown controlled feed action with 5-round detachable box magazine.
- Match grade, hand lapped and precision chambered Shilen barrel in stainless steel with black Gen III coating for superior rust protection.
- Hand-bedded McMillan A-5 fiberglass tactical stock with thumb wheel adjustable cheekpiece and spacer system adjustable length of pull with rubber butt.

The following base model is available in the caliber of your choice:

<i>Base Model</i>	<i>Caliber Groups</i>	<i>Capacity</i>	<i>Barrel Type, Length, Contour</i>	<i>Trigger</i>	<i>Muzzle Brake</i>	<i>Weight</i>
A5 TACTICAL	308, 300 WIN MAG	5 + 1	STAINLESS WITH GEN III COATING, 26", #7	SHILEN	OPTIONAL	12.5 LBS



“No matter the scenario, the Ed Brown A5 Tactical will deliver pin-point accuracy when nothing less is acceptable.”

Gary Paul Johnston, Guns & Weapons for Law Enforcement



100 CRTG, 20MIN
55A2

34-A896

T 92

ED BROWN 1911 HANDGUNS

ENGINEERING EXCELLENCE

All our components including the frame and slide have been redesigned and improved for reliability, accuracy, longevity, and the highest degree of cosmetics. We have engineered many unique and exclusive features such as the Bobtail™, 25 LPI checkering, Snakeskin, and Chainlink. Ed Brown has engineered and tested specific configurations which have been proven to produce excellent accuracy and flawless reliability.

PRECISION MANUFACTURING

We use the highest quality components, regardless of cost. Frames and slides are made from forgings in-house on our own equipment - no other custom manufacturer can match this quality or control. All holes in the frame are located in one setup for a perfect relationship between the holes, allowing more accurate alignment throughout. Most components are CNC machined from barstock. The slide to frame fit is surface ground, with the final lapping done by hand.

HAND CRAFTSMANSHIP

Meticulously hand-fitted, finished and polished by a Brown family member to the highest standards of excellence, with extreme attention to detail. We strongly believe that Ed Brown 1911's are the most accurate and reliable high performance 1911's made anywhere at any price.

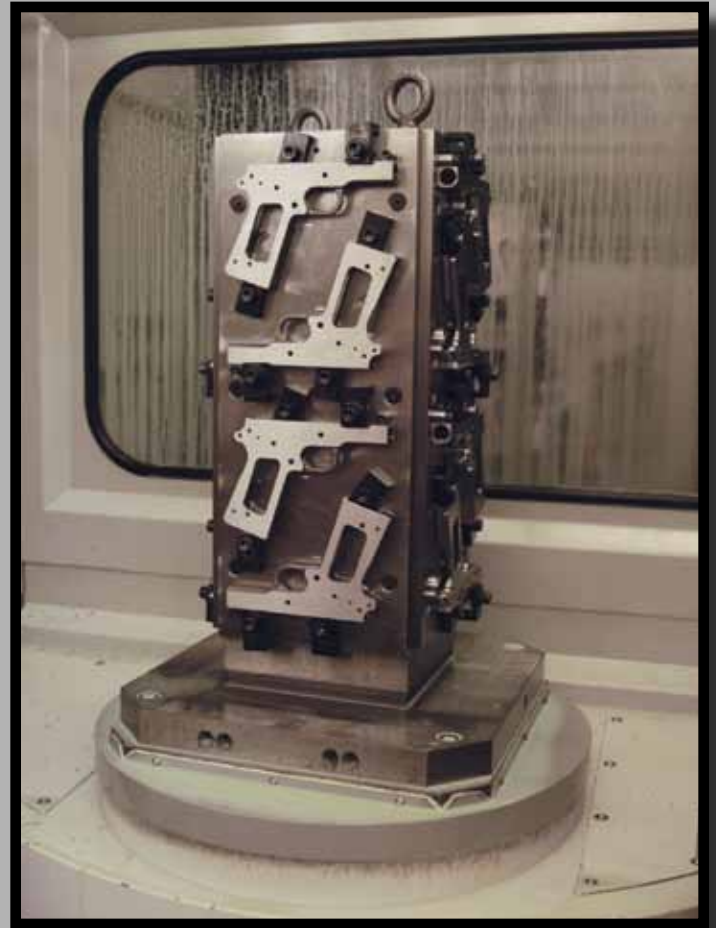

MASTER PISTOLSMITHING DEPARTMENT

“Designing pistols for combat and competition is a lifetime endeavor for this master gun manufacturer.”

Charles Petty, Writer

“After 40 years of shooting 1911's and owning all the other 'custom' brands, the Ed Brown is by far the best handgun I have ever fired. It is a work of art and a pleasure to shoot.

Thank you for making a superb masterpiece.”

Jerry H. Wassel

TECHNICAL SPECIFICATIONS

- Exclusive Ed Brown forged frame and slide, hand fitted with precision for long lasting wear.
- Ed Brown premium **Hardcore®** components are hand-fitted to the exclusive Ed Brown frame.
- All sharp edges are gently and tastefully dehorned.
- Ejection port is lowered and flared for improved ejection.
- Polished feedramp and hand-fit extractor and ejector ensure feeding with high quality ammunition.
- Ed Brown premium match grade barrel and solid steel bushing for the highest accuracy.
- Ed Brown memory groove beavertail grip safety for a higher and deeper grip than any other on the market. Reduces felt recoil and improves natural pointing ability, leading to better accuracy.
- Trigger guard is undercut to allow the knuckle to fully contact the bottom of the trigger guard as a definite stopping point, allowing a more consistent grip.
- “Commander style” slotted and chamfered hammer mated precisely with Ed Brown Perfection sear and Perfection disconnecter. We are the only makers who fully machine each of these critical parts from the highest quality alloy bar stock steel, making for a light trigger pull and crisp break which will last for thousands of rounds.
- Classic “Three hole style” long aluminum trigger.
- Ed Brown seven round magazine with reliable steel follower. Additional magazines tested with gun optional.
- Beveled magazine well for smooth magazine changes.
- Exotic checkered Cocobolo wood grips with traditional double diamond pattern.
- Firearm is rigorously test fired for function and accuracy.
- Ed Brown Products branded deluxe Cordura pistol rug with internal magazine pockets and external zippered accessory pocket.
- All handguns come with Ed Brown Products 1911 Owner’s Manual, cable lock, and Ed Brown Firearm Lubricant #960.
- **All models can be customized, and personalized with laser engraving.**

*“If there is a better 45 ACP out there,
we’d like to see it!”*

Guns & Ammo Staff



Classic Custom

SLIDE LENGTH	5" GOVERNMENT
FRAME	SINGLE STACK GOVERNMENT
WEIGHT	APPROXIMATELY 40 OUNCES WITH AN UNLOADED MAGAZINE INSERTED
SIGHTS	ADJUSTABLE REAR SIGHT CROSS DOVETAIL FRONT SIGHT
FRONTSTRAP/MAINSRING TREATMENT	EXCLUSIVE 25 LPI CHECKERING
COCKING SERRATIONS	TRADITIONAL "SQUARE CUT"
RECOIL SETUP	TWO-PIECE GUIDE ROD
SPECIAL FEATURES	SPECIAL MIRROR FINISHED SLIDE WITH 50 LPI SERRATIONS ON BACK OF SLIDE TOP OF SLIDE FLATTENED AND FINELY GROOVED AT 40 LPI MAG CATCH WITH OVERSIZE 40 LPI BUTTON

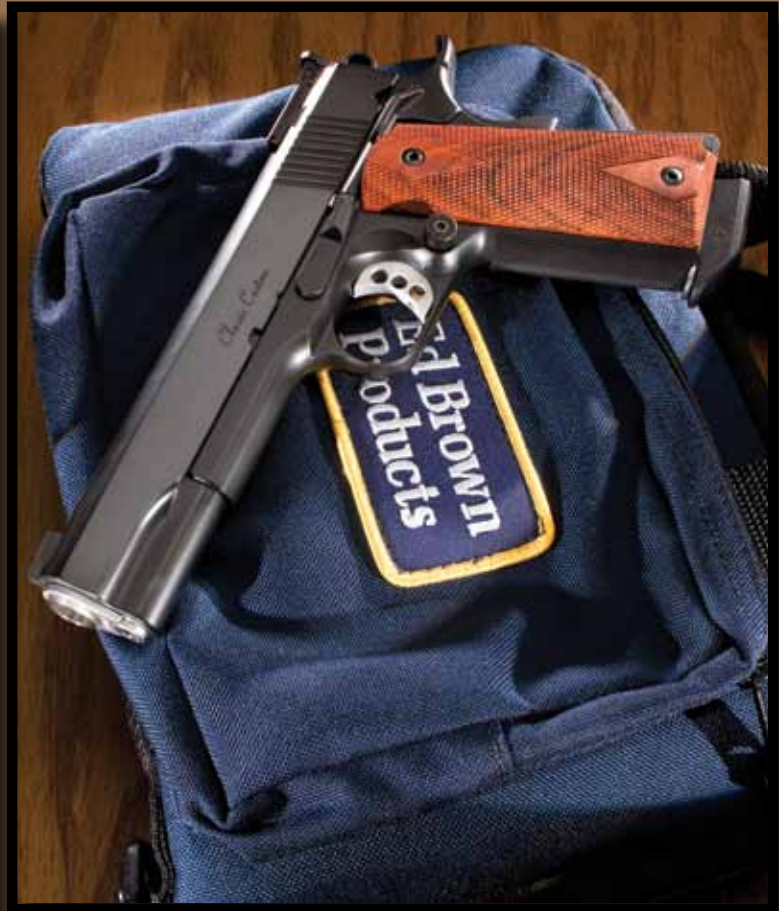
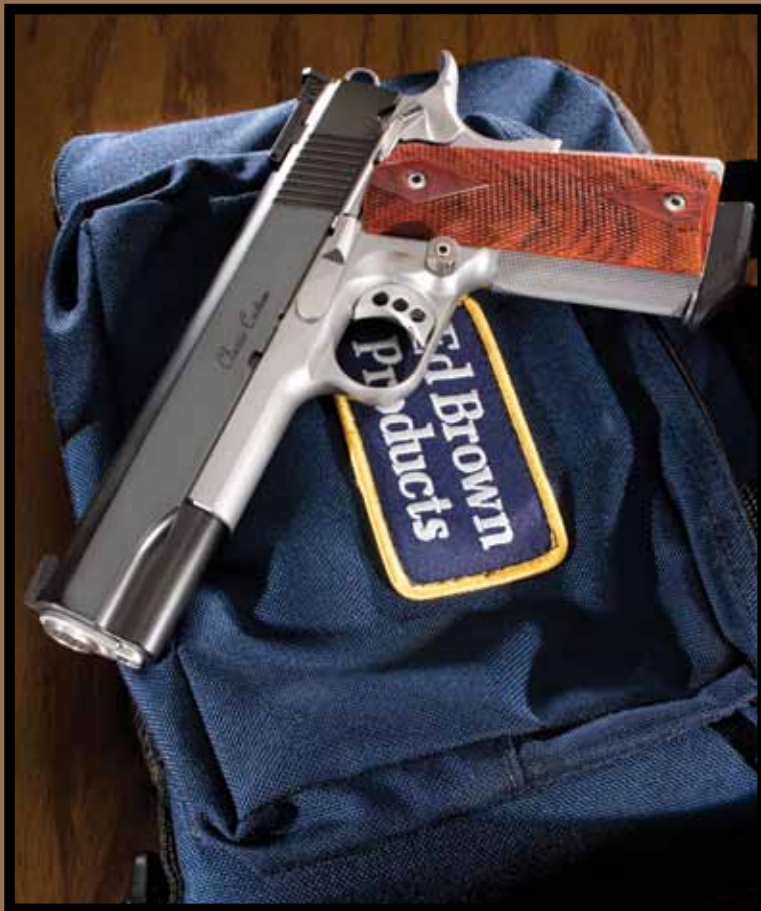

"Ed Brown pistols simply exude quality. I could find no flaw. This is one 1911 that you'll be able to count on."
 Gary Paul Johnson, *Combat Handguns*



EXECUTIVE TARGET

SLIDE LENGTH	5" GOVERNMENT
FRAME	SINGLE STACK GOVERNMENT
WEIGHT	APPROXIMATELY 38 OUNCES WITH AN UNLOADED MAGAZINE INSERTED
SIGHTS	ADJUSTABLE REAR SIGHT CROSS DOVETAIL FRONT SIGHT
FRONTSTRAP/MAINSRING TREATMENT	EXCLUSIVE 25 LPI CHECKERING
COCKING SERRATIONS	TRADITIONAL "SQUARE CUT"
RECOIL SETUP	RECOIL SPRING GUIDE AND PLUG
SPECIAL FEATURES	TOP OF SLIDE IS FLATTENED AND FINELY GROOVED AT 40 LPI





EXECUTIVE TARGET

ED BROWN

10

9

EXECUTIVE ELITE

SLIDE LENGTH	5" GOVERNMENT
FRAME	SINGLE STACK GOVERNMENT
WEIGHT	APPROXIMATELY 38 OUNCES WITH AN UNLOADED MAGAZINE INSERTED
SIGHTS	FIXED DOVETAIL 3-DOT NIGHT SIGHTS WITH HIGH VISIBILITY WHITE OUTLINES
FRONTSTRAP/MAINSRING TREATMENT	EXCLUSIVE 25 LPI CHECKERING
COCKING SERRATIONS	TRADITIONAL "SQUARE CUT"
RECOIL SETUP	RECOIL SPRING GUIDE AND PLUG





20

50 EUR

EXECUTIVE ELITE

EXECUTIVE CARRY

SLIDE LENGTH	4.25" COMMANDER
FRAME	SINGLE STACK COMMANDER BOBTAIL™
WEIGHT	APPROXIMATELY 35 OUNCES WITH UNLOADED MAGAZINE INSERTED
SIGHTS	FIXED DOVETAIL 3-DOT NIGHT SIGHTS WITH HIGH VISIBILITY WHITE OUTLINES
FRONTSTRAP/MAINSRING TREATMENT	EXCLUSIVE 25 LPI CHECKERING
COCKING SERRATIONS	TRADITIONAL "SQUARE CUT"
RECOIL SETUP	RECOIL SPRING GUIDE AND PLUG





EXECUTIVE CARRY

STATE OF ARIZONA
DEPARTMENT OF PUBLIC SAFETY
Concealed Weapons

CONCEALED WEAPON PERMIT

ROBERT

Permit #

Class **W**

Sex **M**

ISSUED BY THE PROCLAMATION OF THE GOVERNOR WITH AN ORDINANCE



KOBRA

SLIDE LENGTH	5" GOVERNMENT
FRAME	SINGLE STACK GOVERNMENT
WEIGHT	APPROXIMATELY 38 OUNCES WITH AN UNLOADED MAGAZINE INSERTED
SIGHTS	FIXED DOVETAIL 3-DOT NIGHT SIGHTS WITH HIGH VISIBILITY WHITE OUTLINES
FRONTSTRAP/MAINSRING TREATMENT	EXCLUSIVE SNAKESKIN
COCKING SERRATIONS	EXCLUSIVE SNAKESKIN
RECOIL SETUP	RECOIL SPRING GUIDE AND PLUG

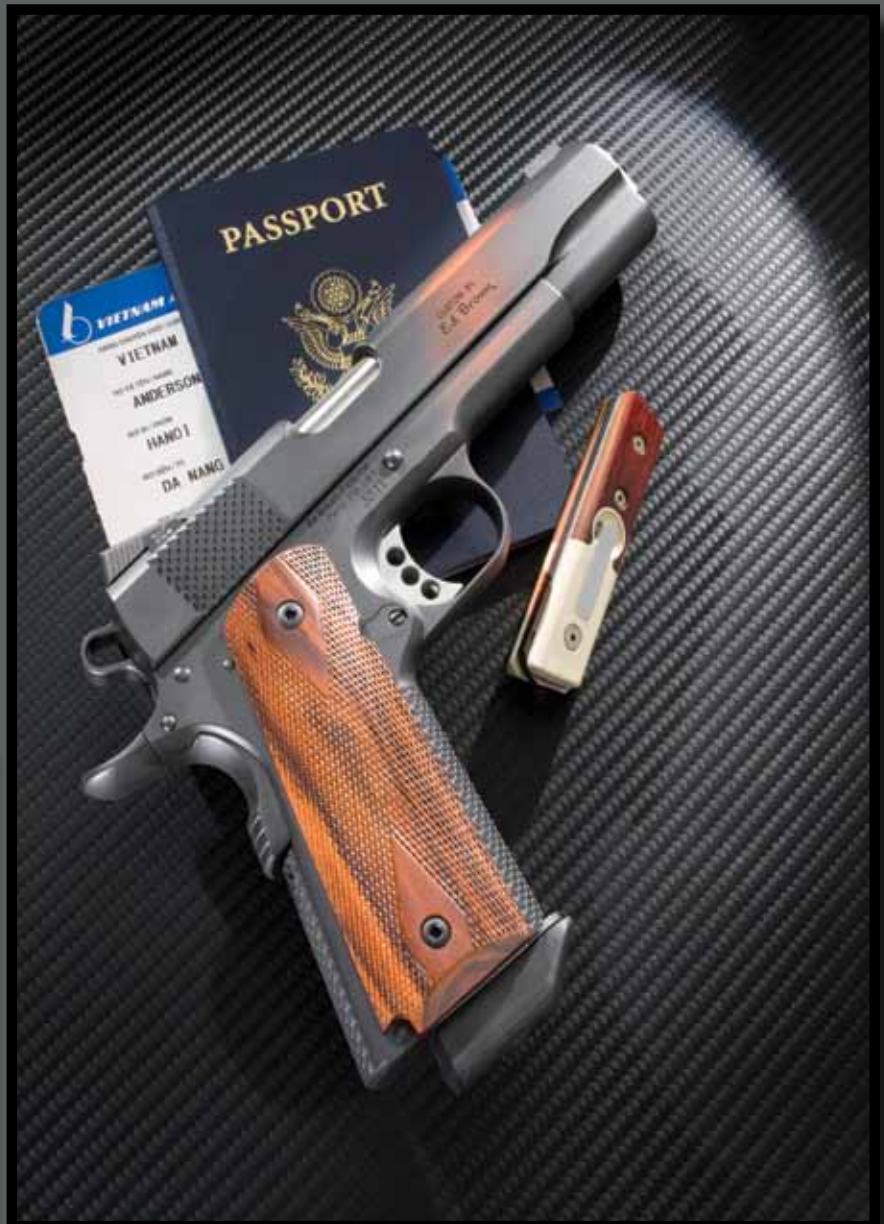



PAS



VIETNAM AIRLINES
HANG CHUYÊN CHỞ / CARRIAGE
VIETNAM
HỌ VÀ TÊN / NAME
ANDERSON
NƠI ĐI / FROM
HANOI
NƠI ĐẾN / TO
DA NANG
KH. C

KOBRA

United States of America



KOBRA CARRY

SLIDE LENGTH	4.25" COMMANDER
FRAME	SINGLE STACK COMMANDER BOBTAIL™
WEIGHT	APPROXIMATELY 35 OUNCES WITH AN UNLOADED MAGAZINE INSERTED
SIGHTS	FIXED DOVETAIL 3-DOT NIGHT SIGHTS WITH HIGH VISIBILITY WHITE OUTLINES
FRONTSTRAP/MAINSRING TREATMENT	EXCLUSIVE SNAKESKIN
COCKING SERRATIONS	EXCLUSIVE SNAKESKIN
RECOIL SETUP	RECOIL SPRING GUIDE AND PLUG



"The Kobra is an outstanding example of the fighting 1911 taken to the pinnacle of perfection."

D.K. Pridgen, *Handguns Magazine*



SPECIAL FORCES

SLIDE LENGTH	5" GOVERNMENT
FRAME	SINGLE STACK GOVERNMENT
WEIGHT	APPROXIMATELY 38 OUNCES WITH AN UNLOADED MAGAZINE INSERTED
SIGHTS	FIXED DOVETAIL 3-DOT NIGHT SIGHTS WITH HIGH VISIBILITY WHITE OUTLINES
FRONTSTRAP/MAINSRING TREATMENT	EXCLUSIVE CHAINLINK
COCKING SERRATIONS	TRADITIONAL "SQUARE CUT"
RECOIL SETUP	RECOIL SPRING GUIDE AND PLUG

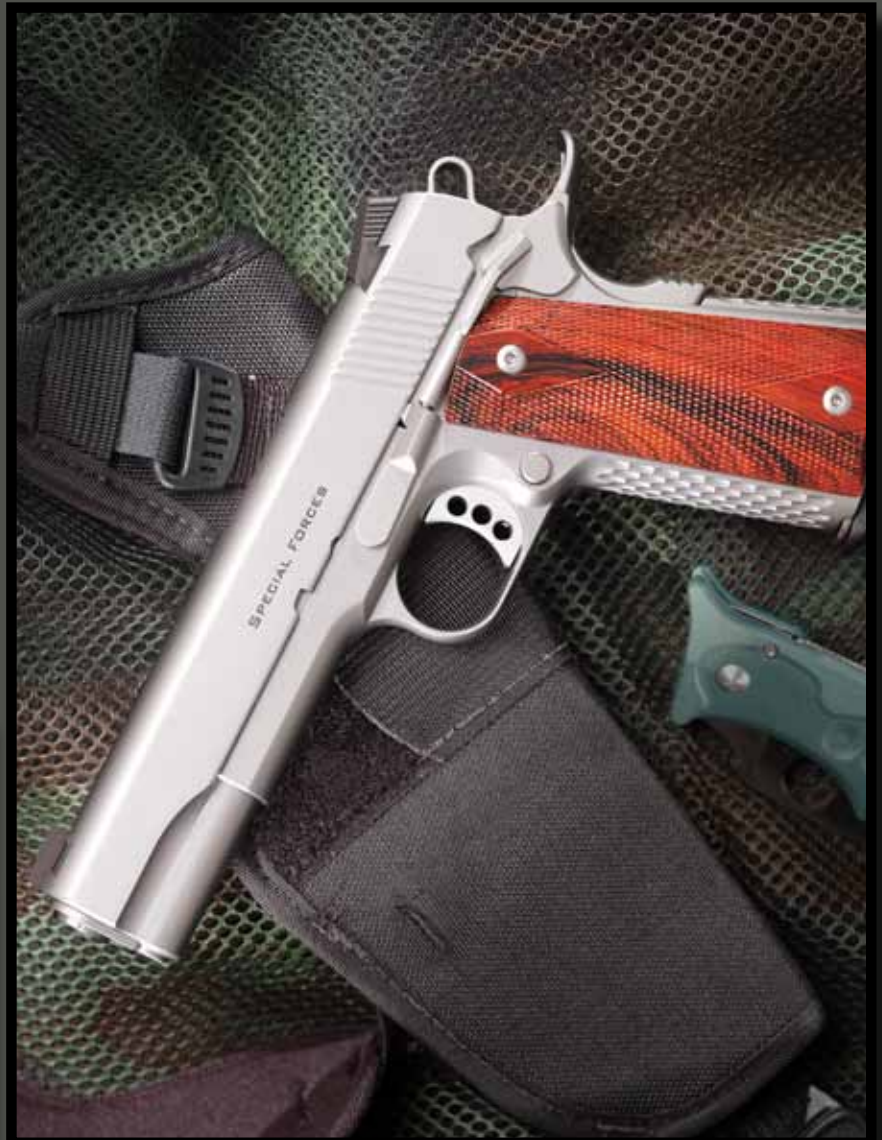



SPECIAL FORCES

SPECIAL FORCES CARRY

SLIDE LENGTH	4.25" COMMANDER
FRAME	SINGLE STACK COMMANDER BOBTAIL™
WEIGHT	APPROXIMATELY 35 OUNCES WITH AN UNLOADED MAGAZINE INSERTED
SIGHTS	FIXED DOVETAIL 3-DOT NIGHT SIGHTS WITH HIGH VISIBILITY WHITE OUTLINES
FRONTSTRAP/MAINSRING TREATMENT	EXCLUSIVE CHAINLINK
COCKING SERRATIONS	TRADITIONAL "SQUARE CUT"
RECOIL SETUP	RECOIL SPRING GUIDE AND PLUG





SPECIAL FORCES

SPECIAL FORCES LIGHT RAIL

SLIDE LENGTH	5" GOVERNMENT
FRAME	SINGLE STACK GOVERNMENT WITH INTEGRAL LIGHT RAIL
WEIGHT	APPROXIMATELY 40 OUNCES WITH AN UNLOADED MAGAZINE INSERTED
SIGHTS	FIXED DOVETAIL 3-DOT NIGHT SIGHTS WITH HIGH VISIBILITY WHITE OUTLINES
FRONTSTRAP/MAINSRING TREATMENT	EXCLUSIVE CHAINLINK
COCKING SERRATIONS	TRADITIONAL "SQUARE CUT"
RECOIL SETUP	RECOIL SPRING GUIDE AND PLUG



*"As to the performance of your pistol,
all I can say is Wow!
The extra work, care, and superior material quality is
evident in your product over your competitors."
Dr. Patton, former Army Special Forces*



SPECIAL FORCES

SUREFIRE
AG8232

FM TRANSCIVER VX-5

YAESU

SET	AR	TH	PRG	CS	TAG	DT	VAT	SFP	SC
1	2	3	4	5	6	7	8	9	0
EMER	MEMO	DISP	AP	ACC	MP	DRPT	SG	WVA	
LOCK	ST	TRF							
PL	PO								

GRIP SAFETIES, THUMB SAFETIES, HOUSINGS



Memory Groove Beavertail Grip Safety

The number one grip safety in the world! More shooters specify the Ed Brown Beavertail than all others combined. Sweeps so high on the gun it is countersunk so a Commander-styled hammer will drop into it. Our grip safety gets your hand as deep into the gun as possible. This reduces felt recoil because it better aligns the centerline of the bore with the axis of your forearm. It also improves natural pointing ability, leading to better accuracy. This grip safety has Memory Grooves machined into a raised pad on the rear for positive depression of the part. With normal use, your hand becomes accustomed to the feel of the grooves, and will remember where the perfect grip is for consistent shooting. The Memory Grooves also aid in depressing the safety for the shooter with thin hands. No need to pin the grip safety! If you have ever failed to activate a grip safety, you need this part! 3D CAD designed to remove the maximum amount of metal from the frame without weakening it, you simply cannot get a better designed part. Uses a .250 radius cut on the frame centered on the thumb safety pin hole. Complete installation instructions included. See our beavertail installation jig #886 for an easy way to establish this .250 radius.

867.....	Beavertail with Memory Groove.....	Series '70'.....	Blue.....	\$34.95
867-1.....	Beavertail with Memory Groove.....	Series '80'.....	Blue.....	\$35.95
868.....	Beavertail with Memory Groove.....	Series '70'.....	Stainless.....	\$34.95
868-1.....	Beavertail with Memory Groove.....	Series '80'.....	Stainless.....	\$35.95

Beavertail Grip Safety Installation Jig

This is an easy to use jig for installing our beavertail grip safety. This heat-treated tool slips into the frame through the thumb safety hole and allows you to make the .250 radius cut on each side of the frame perfect the first time, even if you only have simple hand tools to work with. The jig is heat-treated super hard so hand filing right up against it is okay. The buttons screw together and hold themselves on the gun for easy installation. It is perfect for gauging as well as fine finishing and has great value as a reusable professional tool. Complete installation instructions included.

886.....	Beavertail Grip Safety Installation Jig.....	\$21.95
----------	--	---------

Government Model Mainspring Housings

Ed Brown mainspring housings are fully machined from solid bar stock steel. No cheap castings or plastic is used. Sharp checkering is machine cut into each housing for precision and straightness, then finished by hand. The **SNAKESKIN** housings have scales instead of checkering, as pictured on the Kobra pistol. The **CHAINLINK** housings have scallops which are perfect for durability and a secure grip in severe applications, as pictured on the Special Forces pistol. The arched housings are grooved 20 lpi for a positive gripping surface. The Government Model housing features drop-in installation in all full-size 1911 pistols including full size Para-Ordnance pistols such as the P-14 and P-16. All housings will work great with any finish or type of steel, including aluminum.

816C.....	Mainspring Housing.....	CHAINLINK	Blue.....	\$44.95
816F.....	Flat Mainspring Housing.....	Uncheckered.....	Blue.....	\$29.95
816F25.....	Flat Mainspring Housing.....	25 LPI checkering.....	Blue.....	\$59.95
816S.....	Flat Mainspring Housing.....	SNAKESKIN	Blue.....	\$55.95
817C.....	Mainspring Housing.....	CHAINLINK	Stainless.....	\$44.95
817F.....	Flat Mainspring Housing.....	Uncheckered.....	Stainless.....	\$29.95
817F25.....	Flat Mainspring Housing.....	25 LPI checkering.....	Stainless.....	\$59.95
817S.....	Flat Mainspring Housing.....	SNAKESKIN	Stainless.....	\$59.95
816-ARCH.....	Arched Mainspring Housing with Grooves.....	Blue.....	\$39.95	
817-ARCH.....	Arched Mainspring Housing with Grooves.....	Stainless.....	\$39.95	
816-ARCH-PL.....	Arched Mainspring Housing, Plain.....	Blue.....	\$39.95	

Ambidextrous Safety

The most ergonomic and attractive thumb safety on the market! Widest design 1/4" levers for 'high thumb' shooting style, wider than any of its competitors. This allows the shooter to rest the thumb on top of the safety as Jeff Cooper and others recommend. The tactical version has the levers trimmed to a slender 1/8" profile for better carry and concealment. Shaped for shooting comfort, the lever is angled slightly to keep the thumb from contacting the slide and has a double angle to fit the thumb perfectly. The ambidextrous safety includes both left and right sides needed for the either hand operation. Perfect for certain competitions, left hand shooters, and as a tactical component. May be custom trimmed to any slimmer proportions with no loss of style or function. Designed for all 1911 type frames and made from high quality steel. Requires minor gunsmith fitting for safe operation and includes complete instructions.

892.....	Ambi-Safety, Wide.....	Blue.....	\$54.95
893.....	Ambi-Safety, Wide.....	Stainless.....	\$57.95
892-T.....	Ambi-Safety, Tactical.....	Blue.....	\$54.95
893-T.....	Ambi-Safety, Tactical.....	Stainless.....	\$57.95

Extended Safety

The most ergonomic and attractive thumb safety on the market! Widest design 1/4" levers for 'high thumb' shooting style, wider than any of its competitors. This allows the shooter to rest the thumb on top of the safety as Jeff Cooper and others recommend. The tactical version has the levers trimmed to a slender 1/8" profile for better carry and concealment. Shaped for shooting comfort, the lever is angled slightly to keep the thumb from contacting the slide and has a double angle to fit the thumb perfectly. May be custom trimmed to any slimmer proportions with no loss of style or function. Designed for all 1911 type frames and made from high quality steel. Requires minor gunsmith fitting for safe operation and includes complete instructions.

890.....	Extended Safety, Wide.....	Blue.....	\$29.95
891.....	Extended Safety, Wide.....	Stainless.....	\$31.95
890-T.....	Extended Safety, Tactical.....	Blue.....	\$29.95
891-T.....	Extended Safety, Tactical.....	Stainless.....	\$31.95

Mainspring Housing with Drop-In Maxi-Well

Our standard mainspring housing with a precision machined slot, and a drilled and tapped hole cut into the bottom. This superior two-piece design allows easy, drop-in installation of our included maxi-well, as well as easy removal of the maxi-well in seconds, without disassembling the pistol. Greatly increases magazine well opening for flawless magazine changes and speedy reloading. No grip modifications required.

818C.....	Maxi-Well, CHAINLINK	Blue.....	\$83.95
818F25.....	Drop-In Maxi-Well, Flat, 25 LPI checkering.....	Blue.....	\$73.95
818S.....	Drop-In Maxi-Well, Flat, SNAKESKIN	Blue.....	\$83.95
819C.....	Maxi-Well, CHAINLINK	Stainless.....	\$85.95
819F25.....	Drop-In Maxi-Well, Flat, 25 LPI checkering.....	Stainless.....	\$75.95
819S.....	Drop-In Maxi-Well, Flat, SNAKESKIN	Stainless.....	\$85.95

Bobtail™ Housing

A unique, patented modification to your Government Model frame that transforms it into a round-butt pistol. It consists of a specially manufactured housing and frame modification. The **Bobtail™** removes a full 3/8" of excess metal from the bottom rear of the gun, where the mainspring housing pin is located. This not only reduces the weight, but solves two well-known problems of carrying a 1911. First, it drastically increases comfort during carry. There is no sharp butt to poke you in the ribs. Second, it increases concealment during carry, because the hardest thing to conceal on a 1911 style pistol has always been the sharp, projecting butt. Get our re-useable installation jig to easily locate the new hole in the frame for the **Bobtail™** housing.

816-BT.....	Bobtail™ Housing.....	Plain.....	Blue.....	\$52.95
816C-BT.....	Bobtail™ Housing.....	CHAINLINK	Blue.....	\$62.95
816S-BT.....	Bobtail™ Housing.....	SNAKESKIN	Blue.....	\$62.95
81625-BT.....	Bobtail™ Housing.....	25 LPI checkering.....	Blue.....	\$72.95
817-BT.....	Bobtail™ Housing.....	Plain.....	Stainless.....	\$54.95
817C-BT.....	Bobtail™ Housing.....	CHAINLINK	Stainless.....	\$65.95
817S-BT.....	Bobtail™ Housing.....	SNAKESKIN	Stainless.....	\$65.95
81725-BT.....	Bobtail™ Housing.....	25 LPI checkering.....	Stainless.....	\$75.95
953.....	Bobtail™ Housing Installation Jig.....	Stainless.....	\$42.50	

BARRELS AND GUIDE RODS



Barrel accuracy comes from using the highest quality materials and manufacturing methods. Ed Brown Products is committed to both. Ed Brown barrels are completely manufactured in-house by our own craftsmen, using the most modern CNC machinery and manufacturing methods available. The barrels are made from T-416 modified, gun barrel quality stainless steel bar stock, just like a benchrest rifle barrel. This is without a doubt the best and most reliable way to produce top quality barrels. No forgings are used to try to save a buck. T-416 is certified pure, there are no foreign materials, and no hard or soft spots to worry about. It is stress-relieved and heat-treated prior to final rifling and refinishing. Ed Brown barrels are precision machine cut from a 3 pound chunk bar of this top quality steel. "Our barrels are rifled by precision broach in the original six lands and grooves, one turn in sixteen, left hand twist as originally designed by John Browning. This deep cut, broached rifling gives superior accuracy with all types of bullets, including lead. No cheap, quick pass-through button rifling is used. Our barrels are heat-treated by an aerospace certified heat treat facility, and sub zero frozen for maximum strength and stress relief. This means more accuracy and longer barrel life to the shooter. We have also cut the dimensions to max tolerance on the outside of the barrel. This means less fitting work for you, and more accuracy. Gunsmiths and hobbyists love our precise, pre-fit dimensions on our drop-in models. This gets you on the range quicker enjoying the accuracy improvement your new barrel provides. All this extra trouble and expense ensures you the finest, most accurate barrel possible. These barrels are quite simply the best on the market.

All Ed Brown Guide rods are machined from high quality 416 heat-treated stainless steel. Because of their solid steel design, all one-piece guide rods may be cut down to any length for use in shorter slides. One piece guide rods are also ideal for use with bull barrels. Wrench and plug are included with all two-piece guide rods. All Ed Brown plugs are machined from either blue or stainless, top-quality stress-proof steel. Guide rods smooth out the cycling of the pistol, extend the life of the recoil spring, and add weight to the front of the gun, thus reducing muzzle flip and recoil.

Drop-in Barrels - (bushing, link, and link pin included)

925-45.....5"	45ACP.....Standard feedramp.....	\$185
9243-45.....4.25"	45 ACP.....Standard feedramp.....	\$185

Two-Piece Guide Rod Assembly

Two-piece guide rods are preferred for standard 5" guns because they will disassemble much easier. Will drop-in to all 1911 types with correct slide length. Commander length will fit guns with 4 1/4" barrels. Allen wrench and plug included.

889.....Two-Piece Guide Rod Assembly for 5" slide.....	Stainless.....	\$27.50
889-C.....Two-Piece Guide Rod Assembly for Commander (4.25" slide).....	Stainless.....	\$27.50

Slide Stop

For positive, last round engagement and tighter, longer-lasting lockup with custom barrels. Attractive grooves for positive, non-slip application. Made from hardened tool steel for increased wear. Will fit all 1911 pistols High-Capacity types. The **Hardcore**® slide stop is guaranteed for life against breakage.

810.....Slide Stop.....Blue.....	\$28.95	810-S.....Slide Stop.....	Stainless.....	\$29.95
810-HC..... Hardcore ®.....Blue.....	\$34.95	810-HCS..... Hardcore ®.....	Stainless.....	\$35.95

Standard Recoil Spring Plug

An exact duplicate of the standard 1911 recoil spring plug. For those building, or rebuilding a 1911 desiring the factory configuration.

881-STD.....Recoil Spring Plug.....	Blue.....	\$7.95
881-STD-S.....Recoil Spring Plug.....	Stainless.....	\$8.95
881-CMD.....Recoil Spring Plug for Commander.....	Blue.....	\$7.95
881-CMD-S.....Recoil Spring Plug for Commander.....	Stainless.....	\$8.95

Machined Barrel Links

Match grade barrel jobs need a precisely made link to complete the job. These links are machined from aircraft quality stainless steel bar stock, not stamped.

925.....Standard Barrel Link.....	.278 hole spacing.....	\$6.25
-----------------------------------	------------------------	--------

Solid Barrel Bushings

All spring type collet bushings are subject to breakage and are replaced with the solid type as a rule with professional gunsmiths. We offer a drop-in replacement in blue and stainless that will work on most 1911 types with little or no fitting, and an oversize gunsmith fit version, also in both blue and stainless. Specs: Heat treated alloy and stainless steel. Drop-In: .581 ID, .699 OD. Oversize: .575 ID, .705 OD.

832.....Drop-In Bushing.....	Blue.....	\$18.95
833.....Drop-In Bushing.....	Stainless.....	\$19.95
832-M.....Oversize Bushing.....	Blue.....	\$18.95
833-M.....Oversize Bushing.....	Stainless.....	\$19.95

Recoil Spring Guide

Standard replacement 1911 recoil spring guide, but made from heat treated steel. Used for rebuilding existing guns or assembling new guns in the standard configuration. Available in blue only.

882-STD.....Recoil Spring Guide.....	Blue.....	\$15.00
882-CMD.....Recoil Spring Guide for Commander.....	Blue.....	\$15.00

Standard Guide Rod Plug

As supplied on our Government Model Assembly, now sold separately for those making up special types of their own design, or for use as a replacement.

881.....Standard Plug Only.....	Stainless.....	\$7.95
---------------------------------	----------------	--------

Slide Recoil Buffers

Precisely molded polyurethane buffers mount on the recoil guide and prevent the metal to metal contact that occurs when the gun is fired. Prevents frame damage. Will last about 1,000 rounds. 6 pack.

805.....Slide Recoil Buffers.....	6 pack.....	\$5.95
-----------------------------------	-------------	--------

"Thank you for the outstanding barrel installation you did for me. The fit is really great, plus your turnaround back to me was very quick. My thanks to you folks for a very professional job, the accuracy of course is top notch."

Floyd L. Watkins, Linden, VA

FRAME & SLIDE COMPONENTS

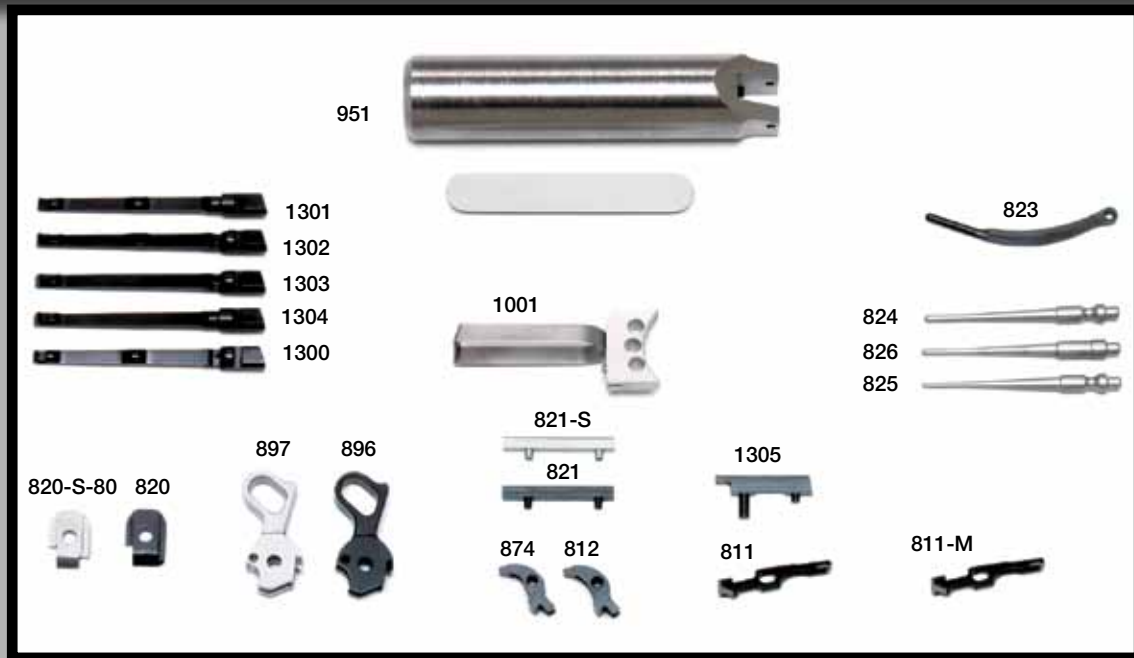

Barstock Hammer with chamfered edges

Completely machined from barstock, these hammers are guaranteed for life against breakage. Improved design with a beautiful chamfer machined all the way around the outside, and also inside the hole. Narrowed half-cock notch eliminates wear damage. Commander style spur, finely serrated for positive gripping surface. Sides are narrowed to eliminate drag on slide. Lowered strut pin hole reduces full-cock spring pressure. Hammer hooks precisely machined at .020-.022 perfectly square with sharp corners, ready for light, final stoning. Made from alloy steel or stainless steel, heat treated Rc 52-54. The perfect mate for this hammer is our #874 Perfection Sear.

896	Hammer	Blue	\$49.95
897	Hammer	Stainless	\$54.95

Perfection Sear

Computer designed and fully machined from top quality bar stock for the perfect profile. Recommended as a perfect fit with our Hammer #896 and #897 for the best trigger pull possible with the least amount of hand labor - no jigs necessary. Hammer contact angle already prepped ready for your favorite clearance angle. Specs: 4340 tool steel, heat treated to 50 Rc.

874	Perfection Sear		\$29.95
-----	-----------------	--	---------

Hammer Strut

Our hammer strut has perfected geometry for the longest lasting wear possible. Made of heat treated tool steel, fits all 1911 types. The obvious choice for competition guns and all rebuilds.

823	Hammer Strut		\$6.95
-----	--------------	--	--------

Match Grade Sear

Our standard model high quality sear for any 1911. Machine-cut from 4340 Alloy steel for longer-wearing, cleaner breaking triggers. Assures positive sear/hammer engagement. Required for fine match grade trigger pull jobs. Requires small amount of hand fitting to hammer for a perfect trigger pull. We recommend our sear jig #951 for this purpose.

812	Sear		\$19.95
-----	------	--	---------

Sear Jig

The one jig you need for the 1911 sear. A larger, rounded design fits comfortably in your hand for ease of use. Packaged with .020 shim and complete instructions that cover every detail of the 1911 trigger job, along with many helpful hints to get the job done right. Made from stainless steel for a rust free life on your bench.

951	Sear Jig		\$37.50
-----	----------	--	---------

National Match Trigger

The classic three hole design long trigger made from strong yet lightweight aluminum, with heat-treated steel bow. Finely serrated pull surface for better feel and control. Includes stainless steel adjustable overtravel set screw. Slightly oversize in height for precise hand fitting to your frame.

1001	National Match Trigger for single stack frames		\$19.95
------	--	--	---------

Disconnecter

Fully machined, heat treated steel for long lasting, increased wear applications. Will work with all 1911 pistols including the Hi-Capacity types.

811	Disconnecter		\$16.95
-----	--------------	--	---------

Perfection Disconnecter

Fully machined from bar stock steel. The only product of it's kind. The strongest available, and heat-treated for long life and extreme service use. Machined surfaces are finely finished and dimensionally exact. Designed to work perfectly with our Perfection Sear and Hammer for precise trigger jobs every time. Will work with all 1911 pistols including the Hi-Capacity types.

811-M	Perfection Disconnecter		\$19.95
-------	-------------------------	--	---------

Plunger Tube

High quality steel plunger tube fully machined from bar stock, with extra length studs for positive crimping. Will work with all 1911 types including the Hi-Capacity types. Don't let a loose, poor quality plunger tube tie up your gun.

821	Blue	\$14.95	821-S	Stainless	\$15.95
-----	------	---------	-------	-----------	---------

Steel Extractors

One of the most common causes of malfunction in the 1911 pistol is a poor extractor. Install one of these and eliminate feeding/extraction problems before they start. Fully machined from aircraft quality heat-treated 4340 alloy steel bar stock for long wear and extra strength.

1301	Extractor, 45ACP	70 Series	Blue	\$23.95
1301-HC	Extractor, 45ACP, Hardcore	70 Series	Blue	\$28.95
1302	Extractor, 45ACP	80 Series	Blue	\$24.95
1302-HC	Extractor, 45ACP, Hardcore	80 Series	Blue	\$29.95
1303	Extractor, 38 Super, 9mm	70 Series	Blue	\$24.95
1304	Extractor, 38 Super, 9mm	80 Series	Blue	\$25.95
1300	Extractor, 40S&W, 10mm	70 or 80 Series	Blue	\$25.95

1911 Firing Pins

Factory firing pins are often weak and subject to failure. These top quality firing pins are precision turned from heat-treated tool steel. Proper weight for positive ignition with heavy duty springs and any type primer. Usable with all 1911 type pistols including Colt Series 80 and 70. Springfield 38 Super and 9mm slides use the oversize diameter pin for heavy loads. At present we are the only manufacturer making the correct size pin for the Springfield 38 Super slides. All Ed Brown, Baer and newer Caspian slides use the 38 Super firing pin, Part #825. If you are unsure which pin you need, measure the diameter near the tip where the pin strikes the primer and compare to the listings. The **Hardcore** firing pin has a LIFETIME guarantee against breakage.

824	Firing Pin, 45ACP	70 or 80, .090 Diameter	\$5.95
824-HC	45 ACP, Hardcore	70 or 80, .090 Diameter	\$9.95
825	Firing Pin, 38, 9mm, 10mm	70 or 80, .065 Diameter	\$5.95
826	Firing Pin, 38, 9mm	Springfield, .075 Diameter	\$5.95

Firing Pin Stop

A high tolerance heat treated alloy steel firing pin stop for all 1911 pistol types. Made to max tolerance on width for a snug fit with the extractor. The standard part is for Series 70 guns, but we also offer an 80 series part which has a relief cut for the 80 series components. Also available as a super tough **Hardcore** part, which carries a LIFETIME guarantee against breakage.

820	Firing Pin Stop	Blue	\$9.95
820-S	Firing Pin Stop	Stainless	\$10.95
820-HC	Hardcore	Blue	\$15.95
820-HCS	Hardcore	Stainless	\$16.95
820-80	Firing Pin Stop for 80 series	Blue	\$9.95
820-S-80	Firing Pin Stop for 80 series	Stainless	\$10.95

Extended Ejectors

One thing you will need for sure in building a reliable pistol is an extended ejector. Essential insurance against failed ejection. Made from heat treated 4140 alloy steel. Requires minor fitting.

1305	Extended Ejector, 45 ACP	Blue	\$21.95
1306	Extended Ejector, 38 Super, 9mm, 10mm	Blue	\$22.95

GUNS SPRINGS & ACCESSORIES



1911 Bench Reference CD-ROM

A complete manual on the 1911 written by Ed Brown, 1991 Pistolsmith of the Year. This CD gives you step-by-step instructions and detailed photos for disassembly, reassembly, maintenance and proper handling. It then goes into complete installation and fitting instructions for practically all accessories. Also included are chapters on trouble shooting and reloading. Packed full of valuable information. A must for all who work on the 1911! Use the electronic search feature, zoom in on photos or diagrams, or print a hardcopy for insertion in a three ring binder as you prefer. Runs on PC or Mac with CD-ROM drive and graphics type operating system such as Windows. Adobe Acrobat Reader included.

Ed Brown Gunsprings

Most shooters set up the gun to suit themselves depending on their load, bullet weight and grip on the gun. You should have the ejected brass land from five to ten feet away from your feet. If the brass falls on your feet, or fails to eject, you need a lighter spring. If the brass lands fifteen to twenty feet away, you need a heavier spring. It is always a good idea to have a replacement spring on hand.

Recoil Springs for Government Models

9165-G.....16.5 pound (Standard)	\$9.95
918-G.....18 pound (Heavy Duty).....	\$9.95
Commander Model	
918-C.....18pound (Standard).....	\$9.95
920-C.....20 pound (Heavy Duty).....	\$9.95

Sear Spring

High-quality, tempered spring with extra length on the center leg that allows precise tuning of the disconnector. Helps prevent disconnector failure and gives positive sear engagement.

822.....Sear Spring	\$4.95
822-HC..... Hardcore	\$6.95

Heavy Duty Firing Pin Spring

For use on all guns for upgrade or replacement.

908.....Heavy Duty Firing Pin Spring.....	\$2.00
---	--------

Light Mag Release Spring

For use on competition guns for faster magazine changes.

909.....Light Mag Release Spring	\$2.00
--	--------

Competition Mainspring for 1911

Mainsprings wear out due to age and use and should be replaced. We recommend this spring rather than the factory standard for a lighter, longer-lasting trigger pull. Plenty of power to set off even the hardest of primers.

919.....Competition Mainspring for 1911.....5 pack.....	\$6.95
---	--------

Ed Brown Pistol Bag

Combination of a padded pistol pouch, 4 padded magazine pouches, and zippered accessory pocket in navy blue Cordura with heavy handles and Ed Brown Logo patch.

965.....Ed Brown Pistol Bag	\$39.95
-----------------------------------	---------

Ed Brown Ball Cap

Top quality ball cap with Ed Brown logo. One size fits all.

961.....Ball Cap	\$12.50
------------------------	---------

Ed Brown Firearm Lubricant

A special blend of synthetic oil intended for the lubrication of Ed Brown 1911's and bolt action rifles. Works perfect with both stainless and blue steel, as well as our Gen III coating. Easy twist open cap never gets misplaced.

960.....1 ounce bottle	\$4.95
------------------------------	--------

WE SELL DIRECT!

PLACE YOUR ORDER
ONLINE AT
WWW.EDBROWN.COM

OR CALL OUR
SALES STAFF AT
573-565-3261

"Your parts are all great quality and the 1911 Bench Reference is easy to follow for a novice like me."
Shay Ben-David

MAGAZINES & MAGAZINE RELEASES

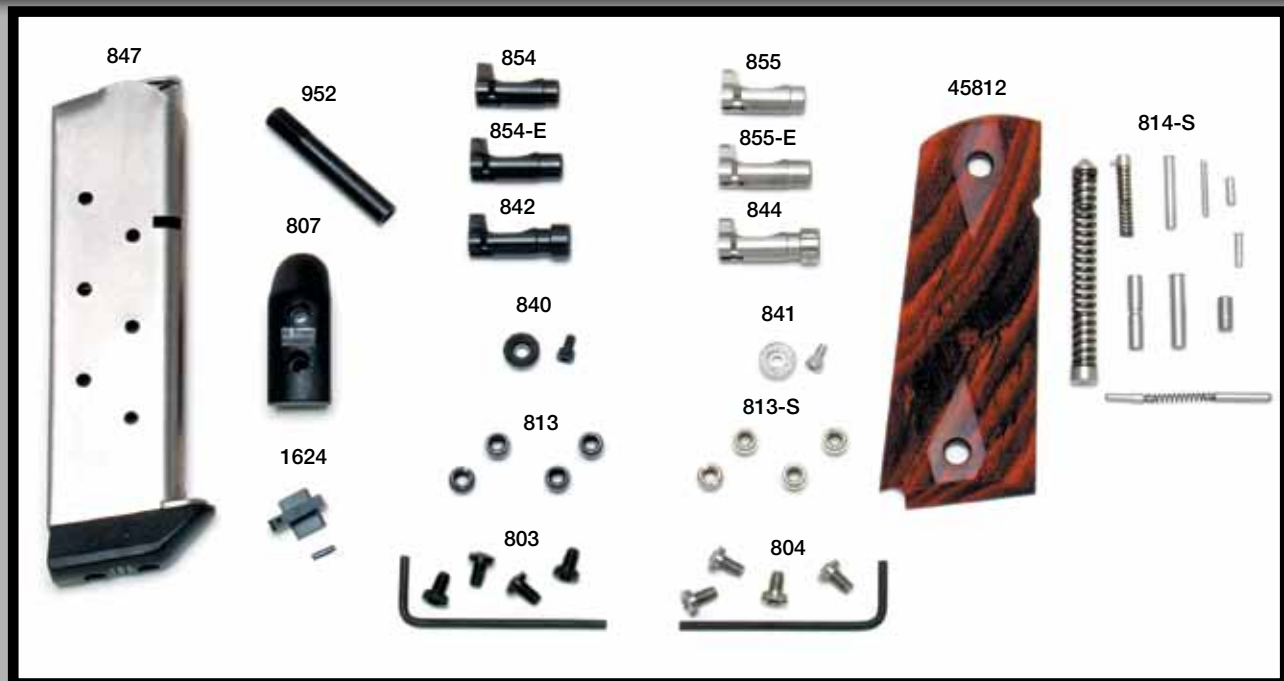

Seven Round Magazine

The classic, most reliable design. Still the best available. A heat treated stainless steel body with rounded steel follower and heavy duty spring provides flawless feeding. Outstanding reliability with all types of ammo. Comes with Ed Brown removable base pad installed.

847 7 Round Magazine..... 45 ACP \$29.95

Magazine Bumper Pads

The same bumper pad as is shipped with our magazines. Durable plastic with the Ed Brown logo molded in. Standard hole spacing. Shipped with two 4-40 self tapping screws for each pad.

807 Magazine Bumper Pads 6 pack \$8.95

Grip Screw Bushings

High quality replacement grip screw bushings. Supplied as a set of four.

813 Blue, set of 4 \$5.49

813-S Stainless, set of 4 \$6.95

Hex Head Grip Screws for 1911 Pistols

An easy way to improve the looks of any 1911. Precision machined hex head grip screws made from high quality tool steel, or 400 series stainless. Heat treated for long lasting wear. Attractive hex head design prevents screwdriver slips. Contoured screw heads blend beautifully with grip panels. Set of four with Allen wrench included.

803 Blue \$6.95

804 Stainless \$7.50

Exotic Cocobolo Wood Checkered Grips

These are the finest grips available for the 1911 frame. Natural exotic wood, no stains or artificial colors are used. Not only are they attractive but they are extremely functional because the wood is so hard the checkering will hold up far better than any walnut can. Favored on all custom guns and match guns alike. Checkered in the original diamond pattern.

45812 Government, Angle cut bottom, Cocobolo \$39.95

Rebuild Kits for 1911 Frame

Includes Mainspring Cap, Mainspring Housing Pin Retainer, Hammer Strut Pin, Hammer Pin, Sear Pin, Mainspring Cap Pin, Magazine Catch Lock, Safety Lock Plunger Assembly, Barrel Link Pin, Ejector Pin, Mainspring Housing Pin, Mainspring, Mag Catch Spring. Every pin and spring needed to rebuild or complete a 1911 style frame.

814 Rebuild Kit Blue \$14.95

814-S Rebuild Kit Stainless \$17.95

Dovetail Front Sights

The best dovetail front sights available. Dependable low mount fixed sights for all types of 1911 pistols. Rounded rear corners designed for smooth carry, but deep precisely machined internal notch for an outstanding sight picture. Cross dovetail front design installs with a single cross cut using the same 65 degree cutter as the rear, is then locked in place with a single roll pin. No more hammering or swaging. Can be installed to work with any rear sight.

1624 Front Sight, Cross Dovetail Post \$19.95

Standard Magazine Release

The original design for the 1911 pistol. Drop-in fit, machined from solid bar stock and heat treated for durability. Beautiful machine cut checkering on button. Fits all single stack 1911 frames. Use existing magazine catch spring and magazine catch lock.

854 Standard Magazine Release Blue \$19.95

855 Standard Magazine Release Stainless \$21.95

Extended Tactical Magazine Release

This part is identical to our Standard Magazine Release, except the button is extended an additional .060 for easier reach and faster magazine changes. Drop-in fit, machined from solid bar stock and heat treated for durability. Beautiful machine cut checkering on button. Does not interfere with tactical style holsters. A positive stop is machined in to prevent over-travel. Fits all single stack 1911 frames. Use existing magazine catch spring and magazine catch lock.

854-E Extended Tactical Magazine Release Blue \$19.95

855-E Extended Tactical Magazine Release Stainless \$21.95

Oversize Magazine Button and Screw Only

An oversize button allows faster and easier magazine changes without shifting your grip. Great for competition or speed shooting. Beautifully checkered 40 lines per inch. The .375 diameter button has a positive stop and the 4-40 hex screw is included. Requires drilling and tapping of a standard factory magazine release.

840 Magazine Release Button Only Blue \$9.49

841 Magazine Release Button Only Stainless \$9.49

Oversize Magazine Release Catch

Identical to the standard magazine catch, but drilled and tapped for our .375 diameter oversize button. The oversize button allows faster and easier magazine changes without shifting your grip, great for competition or speed shooting. Drop-in fit, machined from solid bar stock and heat treated for durability. Button has beautiful machine cut checkering at 40 lines per inch. Includes oversize button & screw. Fits all single stack 1911 frames. Use existing magazine catch spring and magazine catch lock.

842 Magazine Catch Blue w/ Blue Button \$30.49

844 Magazine Catch Stainless w/ Stainless Button \$32.49

Glock Front Sight Installation Tool

The Glock front sight is held on with a screw. Neat idea, but up until now there was no way to get to it. If you own or work on Glocks, you need this tool! This specially designed tool will slip into the many types of magnetic screwdrivers, and allow a professional installation of the Glock front sight screw. Fits all Glocks. Certain Glocks may require opening the hole in the slide just slightly.

952 Glock Sight Tool \$12.50

"Your quality parts and magazines I have used are beyond 1st rate. Nothing but Ed Brown Products for me."

David Keith McGuire, Sequatchie, TN

ED BROWN 8-PACK™ EIGHT ROUND MAGAZINE

THE MOST RELIABLE, HIGHEST QUALITY 8-ROUND MAGAZINE AVAILABLE

The Ed Brown 8-Pack™ was engineered as a true 8 round magazine. It has all the features of the original 7 round magazine that has proven itself over the last century. Features that you know it should have, like a steel follower, heavy duty spring, and super-tough base pad.

The magazine tube has been lengthened and the base pad wraps around securely, to properly accommodate the 8th round while keeping the original ultra-reliable follower design. The integral base pad easily removes for disassembly and cleaning of the magazine. A special hydro-finish process makes this magazine tube and follower very slick, while staying dry to repel dirt and burnt powder. This makes it super easy to load and insert in the gun by eliminating any extra friction against the follower.

The non-slip, oversized base pad allows for a secure grip no matter what the conditions. The 88 blank number templates on the bottom allows you to easily number and track usage of your mags from 0 up to 99 if you desire (think digital numbers on a standard alarm clock). Large, easy to read numbers are laser engraved on both sides of the magazine, in addition to the 8-Pack™ logo.

If you want the most reliable, highest quality 8 round magazine you can buy, look no further than the Ed Brown 8-Pack™.

848.....8-Pack™ 8-round Magazine.....45 ACP.....\$34.95
848-PAD....8-Pack™ spare bumper pad & base lock.....\$6.95



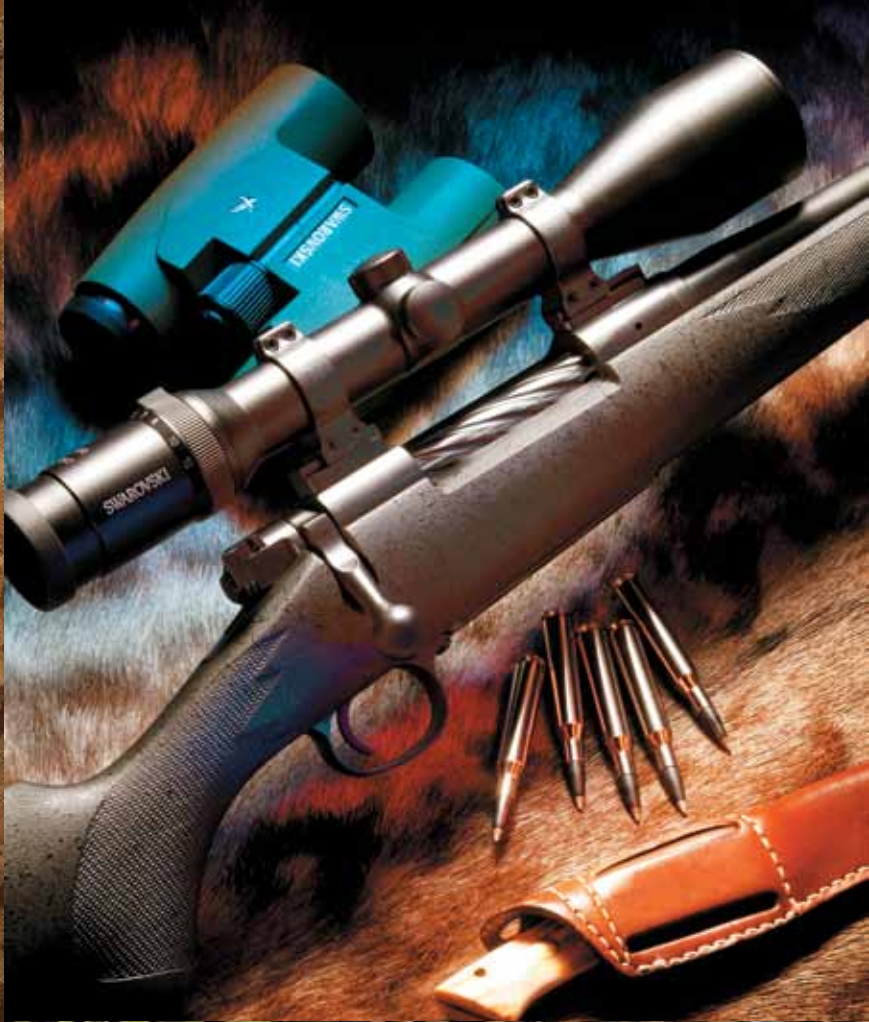



**Ed Brown
Products**

WE'VE ALWAYS MADE
THE ULTIMATE CUSTOM
FIREARMS...
NOW YOU CAN HAVE
THEM PERSONALIZED.

LASER ENGRAVING
OF CUSTOM TEXT OR
GRAPHICS IS NOW
AVAILABLE
EXCLUSIVELY FROM
ED BROWN.



ED BROWN PRODUCTS, INC.
PO BOX 492
PERRY, MD 63462
PHONE: 573-565-3261
FAX: 573-565-2791
WWW.EDBROWN.COM

PRSRST STD
US POSTAGE
PAID
QUINCY, IL 62301
JK CREATIVE

