

RIFLE BASIX

**Remington, Marlin, Savage and Ruger
Aftermarket Replacement Triggers**

Technical Information

**All Rifle Basix triggers are designed to
be 100% drop-in, use factory safeties,
and may be installed by the user.**

Remington Replacement Triggers

Remington 700, 40X and Model 7

Only aftermarket units that are 100% drop-in on model 7's. All Remington 700 triggers feature wide (factory width) finger levers. Adjustable for weight of pull, sear engagement and overtravel. May be user modified for left hand use. All accept factory safeties and bolt release parts.

Available in water resistant zip lock bags, or UPC coded clam shell packaging with peg board display provisions.



L-1

1.5 lbs. to 3 lbs. Pre-adjusted to approx. 2 lbs. Good choice for general purpose hunting.

LV-1

8 oz. to 1.5 lbs. Pre-adjusted to approx. 10 oz. Excellent trigger for varmint hunting.



ERV-3

4 oz. to 1.25 lbs. Pre-adjusted to approx. 6 oz. Suitable for target use or serious varmint hunting

L-3

2 oz. to 6 oz. Pre-adjusted to approx. 2 oz. Target trigger.

Installation Tips

Remington receivers are “staked” on the underside beneath the mounting pins, after the factory triggers and pins have been assembled. These mounting pins are not meant to be removed. Pins must be DRIVEN out in order to remove. DO NOT re-install these pins until they have been re-fitted to the receiver. The pins may be chucked in a drill motor (like a drill bit) and reduced in diameter with 320 wet or dry sandpaper until they can be easily tapped into the receiver. Do not attempt to install any replacement trigger until, and unless, these mounting pins have been pre-fitted to the receiver FIRST.

Use of Factory Safety on ERV-3's & L-3's

Factory safeties may be used “as is” on L-1's & LV-1's. To use factory safeties on ERV-3's and L-3's, a very small notch must be ground onto your safety to allow the safety to be moved to the FULL “FIRE” position. If this notch is not ground, the safety lever will interfere with the 2nd lever re-set spring anchor pin, and will leave the safety in the “SAFE” position. It is suggested in the Instruction Sheet, the safety lever and it's pivot pin only, be installed temporarily in a “mock-up” installation, moved back and forth from “SAFE” to “FIRE” to determine where the interference occurs, and to see why and where to grind this notch BEFORE grinding. A photo of a factory safety with the notch ground is shown in the Instruction Sheet.

Left Hand Use



All Remington triggers shipped in right hand configuration.

By tapping finger lever pivot pin → through to opposite side, trigger will accept left hand bolt release.

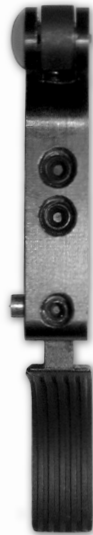

Trigger should be supported by wooden spool on "Rifle Basix" side when tapping pin.

Remington 600-660 "Mohawk"

Available in water resistant zip lock bags only.



600-1
.375

1.5 lbs. to 3 lbs. Pre-adjusted to approx. 2 lbs. Good choice for general purpose hunting.

600V-1
.375

8 oz. to 1.5 lbs. Pre-adjusted to approx. 10 oz. Excellent trigger for varmint hunting.



600-1
.500

Same as above with 1/2" safety spacing.

600V-1
.500

Same as above with 1/2" safety spacing.



Remington 600 Safety Spacing:

.375 (3/8")

or

.500 (1/2")

Dimensions from center line of safety pivot pin, to center line of detent ball.

Determine which safety you have, to order the correct trigger

Remington XP-100

XP-100 center grip pistols. Available in water resistant zip lock bags only.

Designed to re-use factory linkage bars, finger lever & mounting brackets with sear adjustment screw. Trigger furnished with new linkage bar connecting pin.

Disassembly of factory triggers must be done carefully to retain function of all hardware which must be re-used in installation.

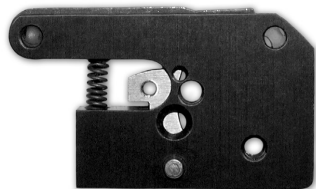

XP-1

1 lb. to 2 lbs.

May use factory safeties.

XPV-1

8 oz. to 1 lb.

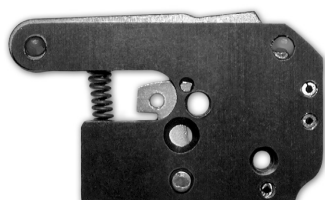

XP-3

2 oz. to 6 oz.

No safety provisions

Marlin Replacement Triggers

Bolt action rimfire rifles. Designed to be 100% drop-in, use factory safeties and may be installed and adjusted by the user.

Available in water resistant zip lock bags, or UPC coded clam shell packaging with peg board display provisions.



MAR-1

All bolt action rimfire rifles manufactured before 2004.

14 oz. to 2 lbs.

Instruction Sheet and hardware package included.



MAR-917

2004 models with T-900 trigger system.

Models 915, 917, 925, 980, 981, 982, and 983

14 oz. to 2 lbs.

Instruction Sheet and hardware package included.

Savage Replacement Triggers

These triggers replace all bolt action 110 type rifle triggers manufactured after January 1966. Designed to be 100% drop-in, and may be installed and adjusted by the user. For long, medium and short actions, both left and right hand. Replaces the standard Savage triggers AND the new Accutrigger. ALL factory safeties remain functional.

Available in water resistant zip lock bags, or UPC coded clam shell packaging with peg board display provisions.



SAV-1

14 oz. to 3 lbs.

Instruction Sheet and hardware package included.

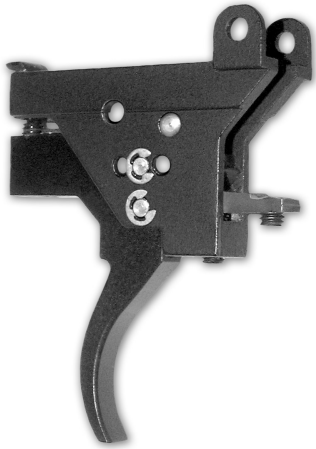

SAV-2

Available in clam shell packaging only.

Replaces all 110 series triggers, INCLUDING the AccuTrigger. ALL factory safeties remain functional.

4 oz. to 3 lbs. Includes all necessary hardware.

Shipped with 32 minute CD-ROM Instructional Video - unique in the industry. Optional VHS Instructional Videotape available at nominal cost.

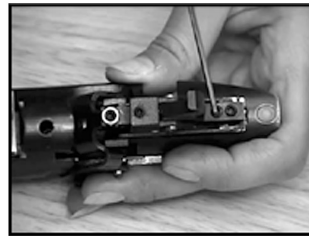
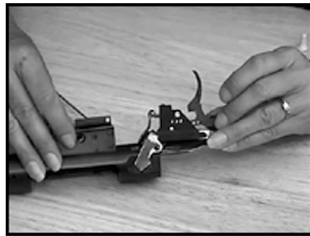

SAV-3

Centerfire "Striker" pistols 510-516 models.

14 oz. to 1.5 lbs.

Instruction Sheet and hardware package included.

* Optional linkage pin available for 2nd generation "Strikers".

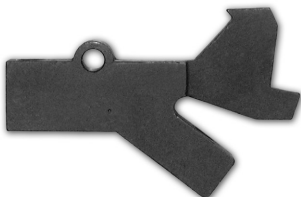

SAV-R

Bolt action Rimfire rifles. Models Mark I & Mark II, model 93 .22 magnums and .17 calibers. Also fits models 501, 502, & 503 Rimfire "Striker" pistols.

10 oz. to 1.5 lbs.

Instruction Sheet and hardware package included.

Ruger Replacement Triggers

Bolt action centerfire and rimfire models. Designed to be 100% drop-in, all use factory safeties, and may be installed and adjusted by the user.

Available in water resistant zip lock bags, or UPC coded clam shell packaging with peg board display provisions.

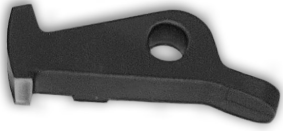

RU-T

Replacement sear - early centerfire Rugers with Tang safety

Adjustable 14 oz. to 2 lbs.

Instruction Sheet included.



RU-MK II

Current production M77 MK II - and the new .204 Ruger

“Optimized” sear engagement

“Limited” overtravel

Adjustable 14 oz. to 2.5 lbs.

Instruction Sheet and hardware package included.

RU-MK II (L.H.)

Same as above - LEFT HAND



RU-R

Current production 77/.22 & 77/.17 Rimfire

“Optimized” sear engagement

“Limited” overtravel

Adjustable 1.5 lbs. to 3 lbs.

Instruction Sheet and hardware package included.